



# CABINET HARDWARE SYSTEMS

## TOPAZ SLIMLINE DRAWER SYSTEM

# #DSY-TSL

### Australia

1800 008 591 ■ [www.artia.com.au](http://www.artia.com.au)

**VICTORIA:**

235 Settlement Road,  
Thomastown VIC 3074

**NEW SOUTH WALES:**

6 Nello Place  
Wetherill Park NSW 2164

**QUEENSLAND:**

Building 2/660 MacArthur  
Avenue, Pinkenba QLD 4008

**SOUTH AUSTRALIA:**

13 Rosberg Road,  
Wingfield SA 5013

**WESTERN AUSTRALIA:**

Unit 5/1 Dellamarta Road,  
Wangara WA 6065

### New Zealand

0800 267 625 ■ [www.artia.co.nz](http://www.artia.co.nz)

**AUCKLAND:**

11 Bruce Roderick Drive,  
East Tamaki, Auckland 2013

**CHRISTCHURCH:**

117 Wrights Road,  
Addington, Christchurch 8024

# TOPAZ SLIMLINE DRAWER SYSTEM

## CONTENTS

▪ H86 Standard, 86mm high .....	06
▪ H86 Drawer Configuration .....	06
▪ H86 Technical Information .....	07
▪ H118 Maxi, 118mm high.....	08
▪ H118 Drawer Configuration .....	08
▪ H118 Technical Information.....	09
▪ H167 Mid-height, H167mm high.....	10
▪ H167 Drawer Configuration .....	10
▪ H167 Technical Information.....	11
▪ H199 Tall, 199mm high .....	12
▪ H199 Drawer Configuration .....	12
▪ H199 Technical Information.....	13
▪ Index.....	22

# TOPAZ SLIMLINE DRAWER SYSTEM



# TOPAZ

Slimline Drawer System

# TOPAZ SLIMLINE DRAWER SYSTEM

## ELEGANT FUNCTIONALITY

12.9mm slim sidewalls add a touch of light elegance to your cabinetry. Tall sidewalls ensure that nothing gets lost.

## OPTIMUM SPACE UTILISATION

With right angles inside and out, the slimline profile maximises internal drawer space.

## ALL BASES COVERED

Four different heights H86, H118, H167 and H199 times five drawer lengths NL350 to NL550 cover every requirement.

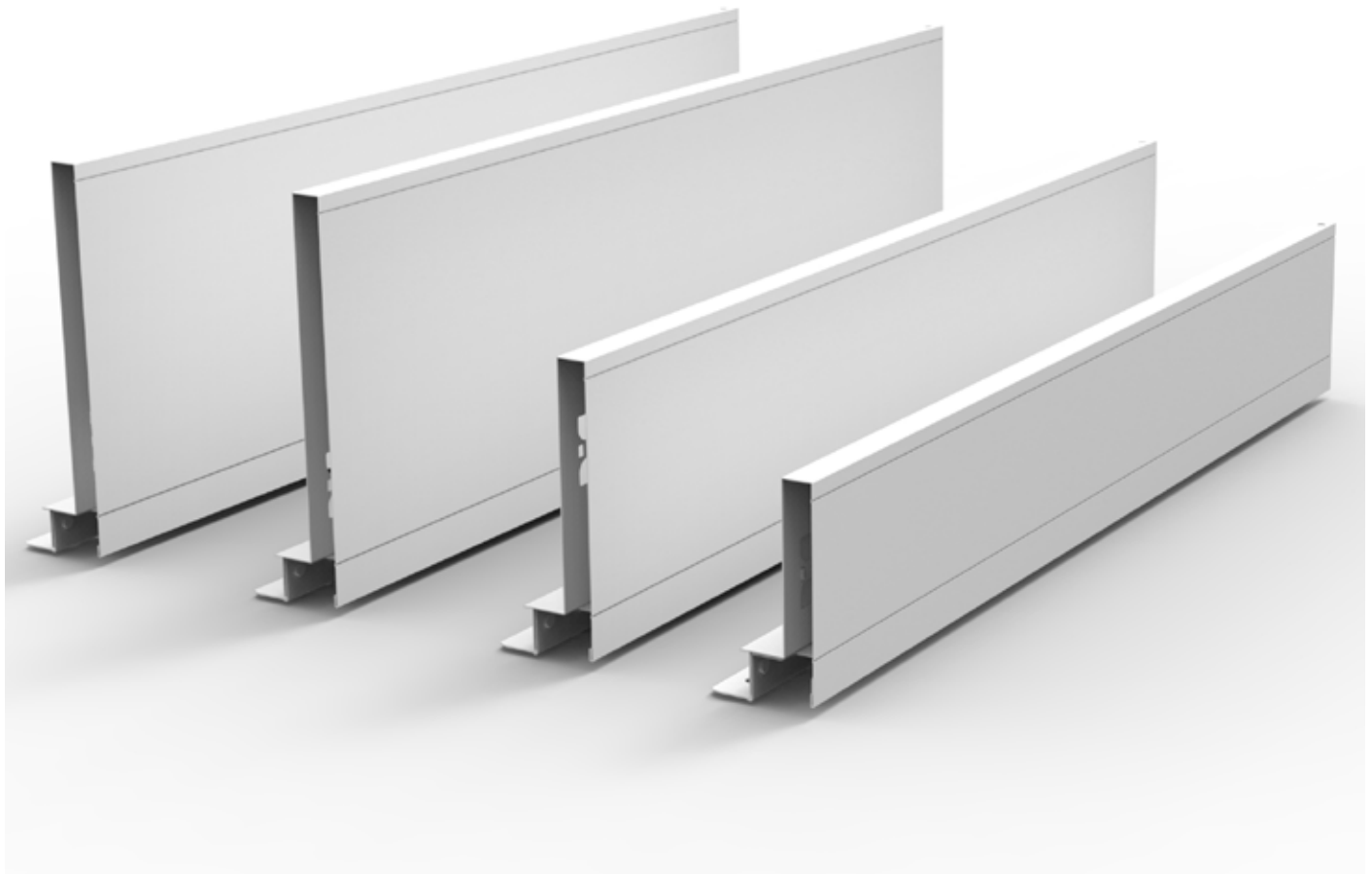

# TOPAZ SLIMLINE DRAWER SYSTEM

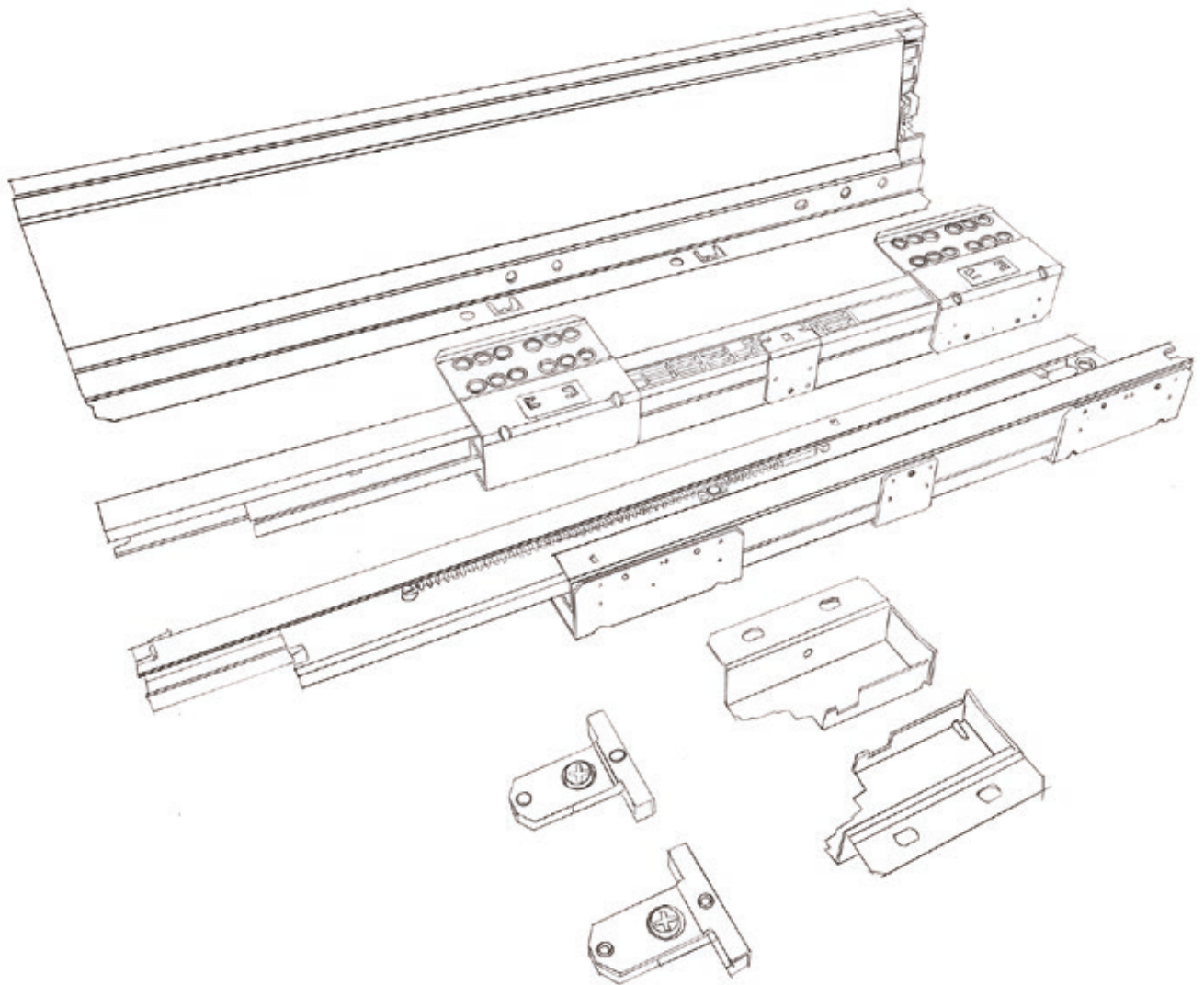

## **SMOOTH**

Synchronised runners ensure that even wide drawers run without hiccup. The soft-close feature adds the finishing touch.

## **STRONG**

The 40kg load capacity ensures that the TOPAZ Slimline Drawer System is up to the job, all day everyday.

## **TRIED AND TESTED**

Quality as proven with 80,000 opening and closing cycles.

## **PLANNING FLEXIBILITY**

Modular system for optimum stock planning and ability to react to short-term specification changes.

# TOPAZ SLIMLINE DRAWER SYSTEM

## TOPAZ SLIMLINE DRAWER H86

### ► H86 Standard, 86mm high



- Standard height 86mm, perfect for a bank of five standard drawers
- Synchronised soft-closing slide runners
- 40 kg load capacity
- Wide range of drawer lengths NL350 to NL550mm
- 3D drawer front adjustment, up & down  $\pm 1.5$ mm, left & right  $\pm 1.5$ mm
- Choice of screw-fix or expanding dowel front brackets

### ► H86 Drawer Configuration

#### A TSL1 Soft-closing drawer slides (pair)

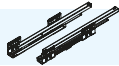

Length	CODE
NL350	TSL1.NL350.SC
NL400	TSL1.NL400.SC
NL450	TSL1.NL450.SC
NL500	TSL1.NL500.SC
NL550	TSL1.NL550.SC

#### B TSL2 - H86 Drawer sides, 86mm high (pair)



Length	CODE
NL350	TSL2.H86.350.W
NL400	TSL2.H86.400.W
NL450	TSL2.H86.450.W
NL500	TSL2.H86.500.W
NL550	TSL2.H86.550.W

#### C TSL3 - H86 Front connector brackets for H86 drawers (pair)

Type	CODE
SCREW-FIX H86	TSL3.FB86.S
EXPANDING DOWEL H86	TSL3.FB86.D

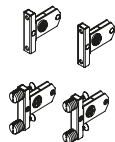

#### D TSL4 - H86 Rear brackets for H86 drawers (pair)

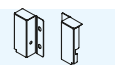

Type	CODE
H86	TSL4.RB86.W

Component view

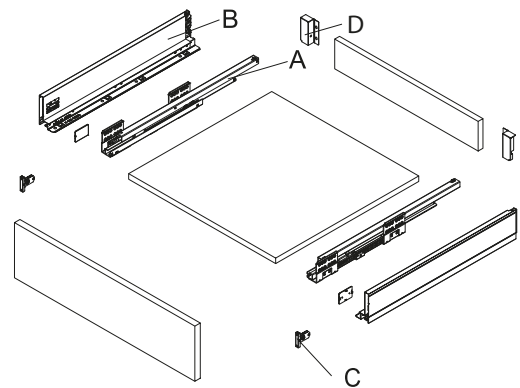

# TOPAZ SLIMLINE DRAWER SYSTEM

TOPAZ SLIMLINE DRAWER H86

## ► H86 Technical Information

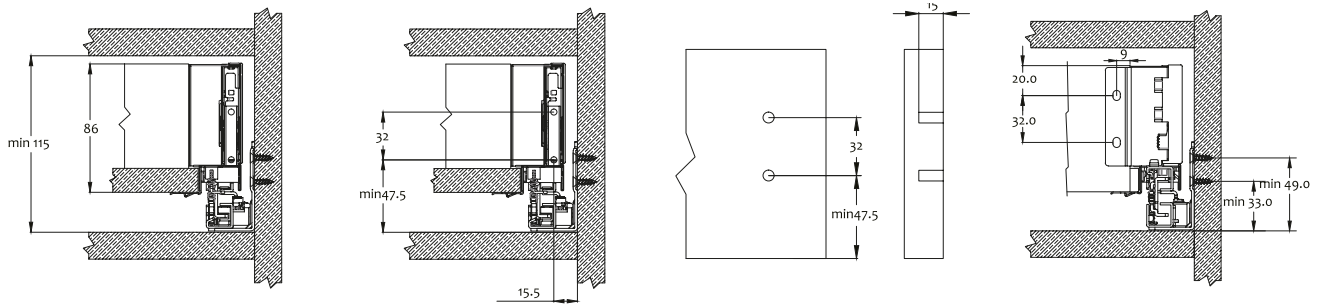

## DRAWER SLIDE DIMENSIONS

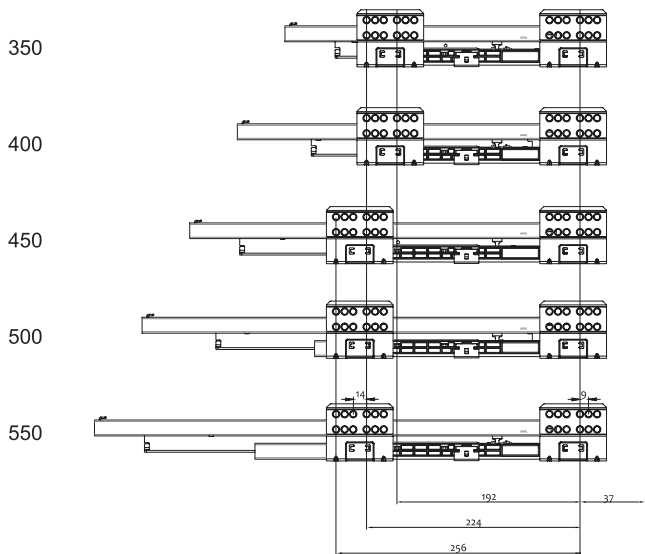

## CUTTING DIMENSIONS

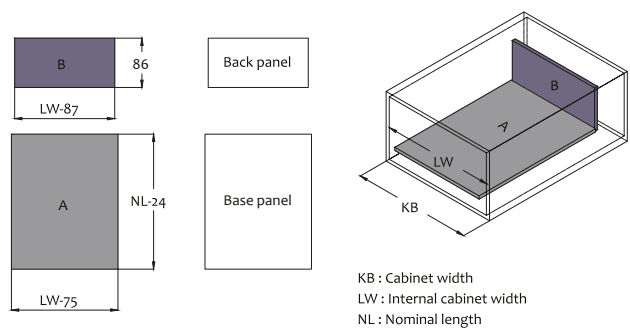

## SPACE REQUIREMENTS

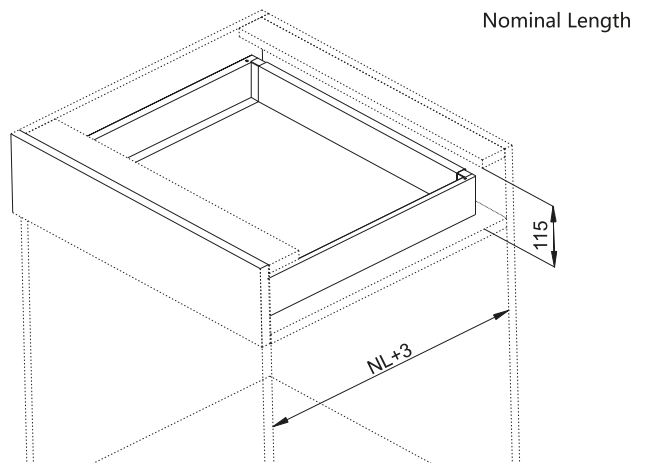
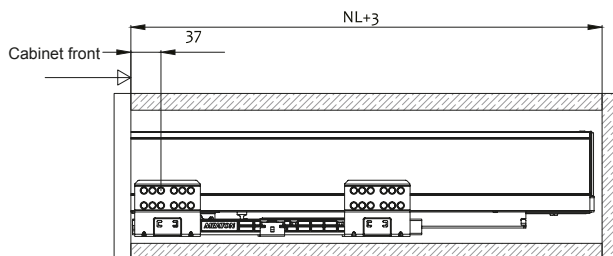

# TOPAZ SLIMLINE DRAWER SYSTEM

## TOPAZ SLIMLINE DRAWER H118

### ► H118 Maxi, 118mm high

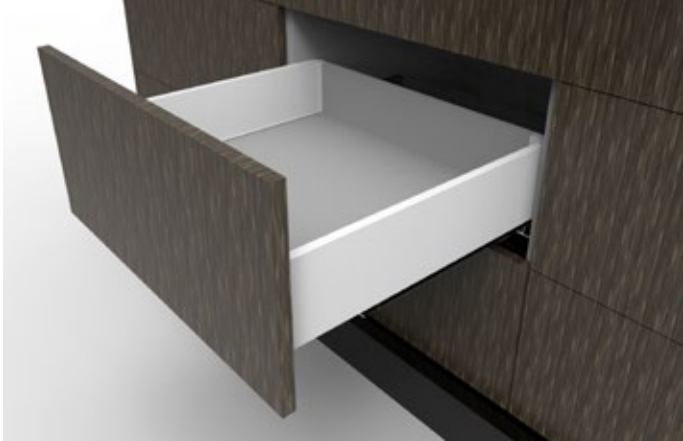

- Maxi height 118mm, ideal for a bank of four added height standard drawers
- Synchronised soft-closing slide runners
- 40 kg load capacity
- Wide range of drawer lengths NL350 to NL550mm
- 3D drawer front adjustment, up & down  $\pm 1.5\text{mm}$  left & right  $\pm 1.5\text{mm}$
- Choice of screw-fix or expanding dowel front bracket

### ► H118 Drawer Configuration

#### A TSL1 Soft-closing drawer slides (pair)

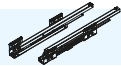

Length	CODE
NL350	TSL1.NL350.SC
NL400	TSL1.NL400.SC
NL450	TSL1.NL450.SC
NL500	TSL1.NL500.SC
NL550	TSL1.NL550.SC

#### B TSL2 - H118 Drawer sides, 118mm high (pair)

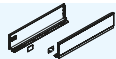

Length	CODE
NL350	TSL2.H118.350.W
NL400	TSL2.H118.400.W
NL450	TSL2.H118.450.W
NL500	TSL2.H118.500.W
NL550	TSL2.H118.550.W

#### C TSL3 - H118 Front connector brackets for H118 drawers (pair)

Type	CODE
SCREW-FIX H118	TSL3.FB118.S
EXPANDING DOWEL H118	TSL3.FB118.D

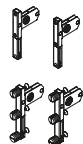

#### D TSL4 - H118 Rear brackets for H118 drawers (pair)



Type	CODE
H118	TSL4.RB118.W

Component view

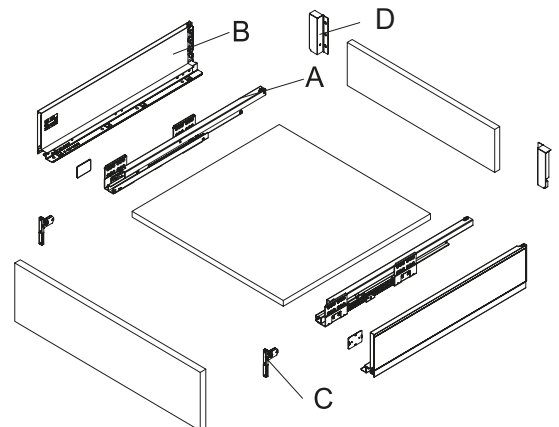



# TOPAZ SLIMLINE DRAWER SYSTEM

TOPAZ SLIMLINE DRAWER H118

## ► H118 Technical Information

Cabinet space requirements

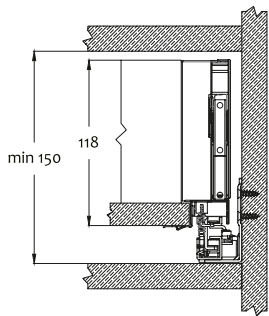

Mounting dimensions  
Front brackets

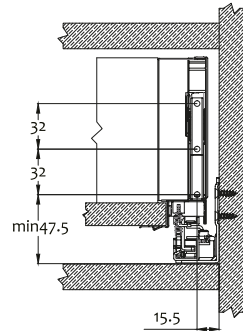

Drilling dimensions  
Front panel

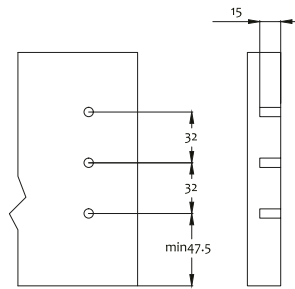

Mounting dimensions  
Back panel

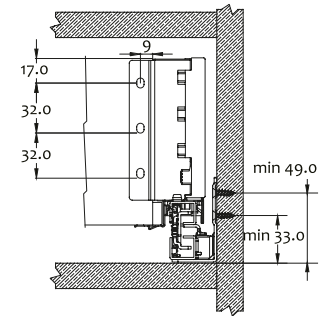

## DRAWER SLIDE DIMENSIONS

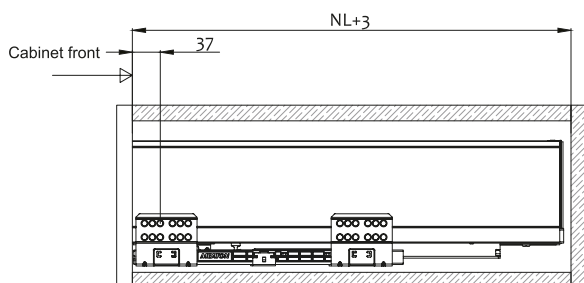
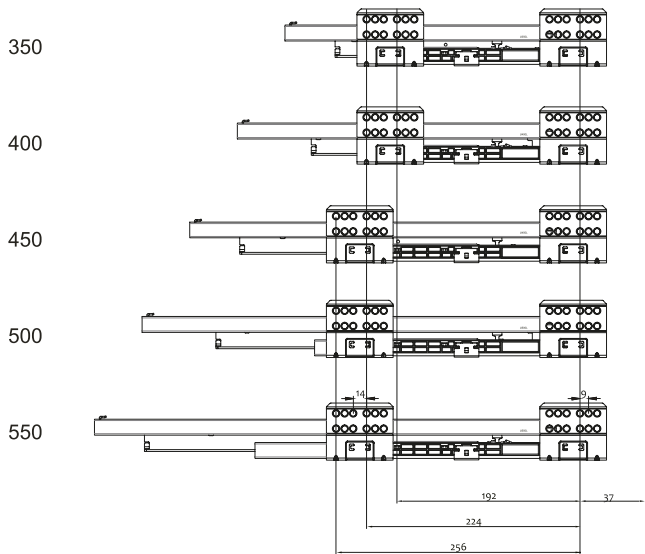

## CUTTING DIMENSIONS

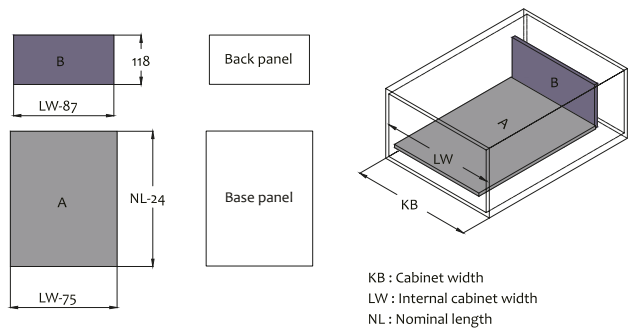

## SPACE REQUIREMENTS

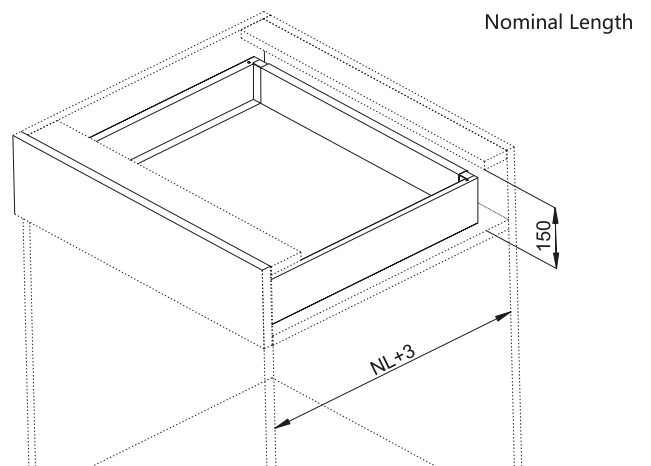

# TOPAZ SLIMLINE DRAWER SYSTEM

## TOPAZ SLIMLINE DRAWER H167

### ► H167 Mid-height, H167mm high



- Mid-height 167mm, perfect for wardrobes
- Synchronised soft-closing slide runners
- 40 kg load capacity
- Wide range of drawer lengths NL350 to NL550mm
- 3D drawer front adjustment, up & down  $\pm 1.5$ mm, left & right  $\pm 1.5$ mm
- Choice of screw-fix or expanding dowel front brackets

### ► H167 Drawer Configuration

#### A TSL1 Soft-closing drawer slides (pair)

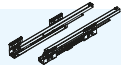

Length	CODE
NL350	TSL1.NL350.SC
NL400	TSL1.NL400.SC
NL450	TSL1.NL450.SC
NL500	TSL1.NL500.SC
NL550	TSL1.NL550.SC

#### B TSL2 - H167 Drawer sides, 167mm high (pair)

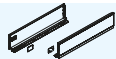

Length	CODE
NL350	TSL2.H167.350.W
NL400	TSL2.H167.400.W
NL450	TSL2.H167.450.W
NL500	TSL2.H167.500.W
NL550	TSL2.H167.550.W

#### C TSL3 - H167 Front connector brackets for H167 drawers (pair)

Type	CODE
SCREW-FIX H167/199	TSL3.FB167.199.S
EXPANDING DOWEL H167/199	TSL3.FB167.199.D



#### D TSL4 - H167 Rear brackets for H167 drawers (pair)



Type	CODE
H167	TSL4.RB167.W

Component view

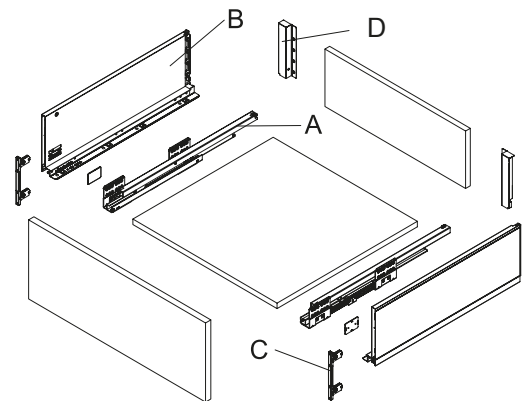

# TOPAZ SLIMLINE DRAWER SYSTEM

TOPAZ SLIMLINE DRAWER H167

## H167 Technical Information

Cabinet space requirements

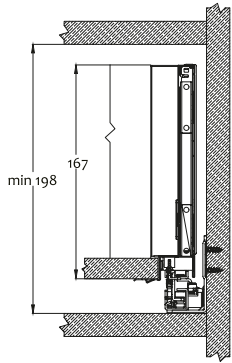

Mounting dimensions  
Front brackets

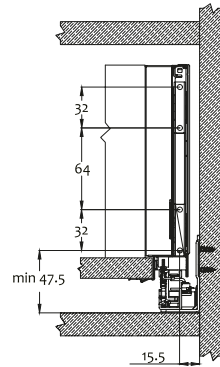

Drilling dimensions  
Front panel

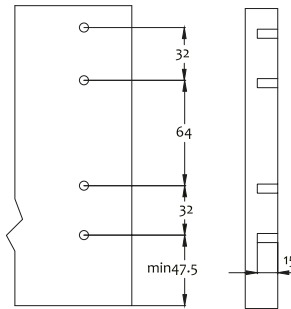

Mounting dimensions  
Back panel

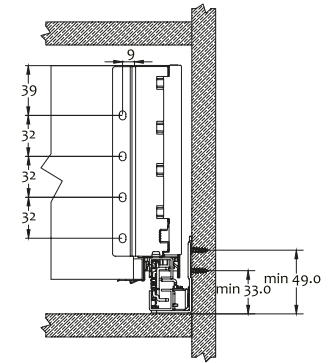

## DRAWER SLIDE DIMENSIONS

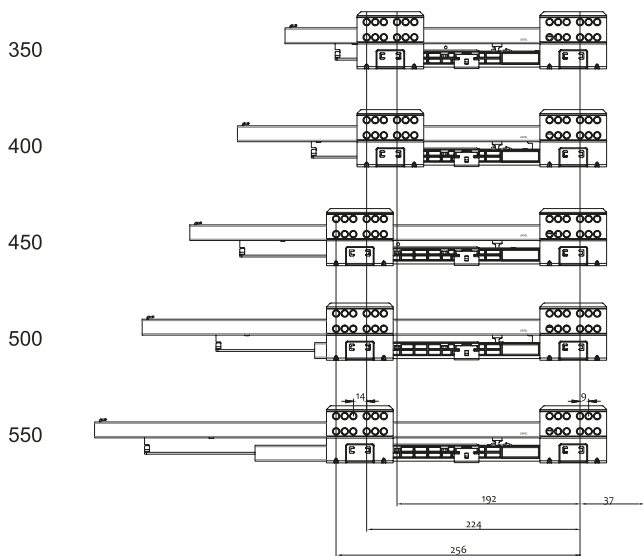

## CUTTING DIMENSIONS

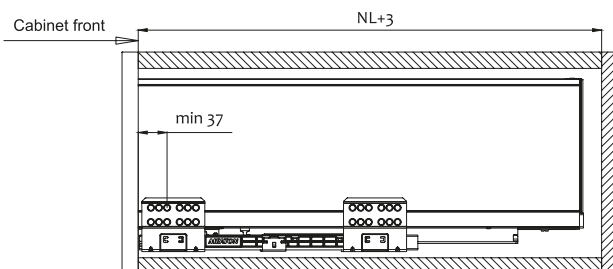
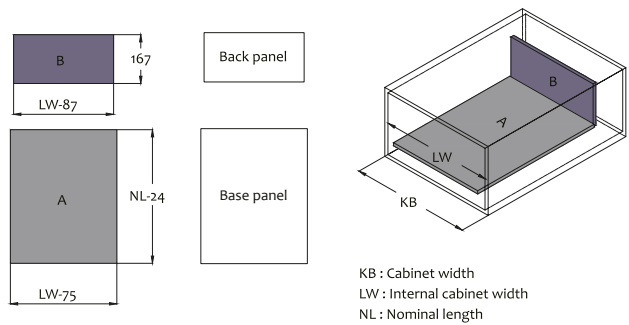

## SPACE REQUIREMENTS

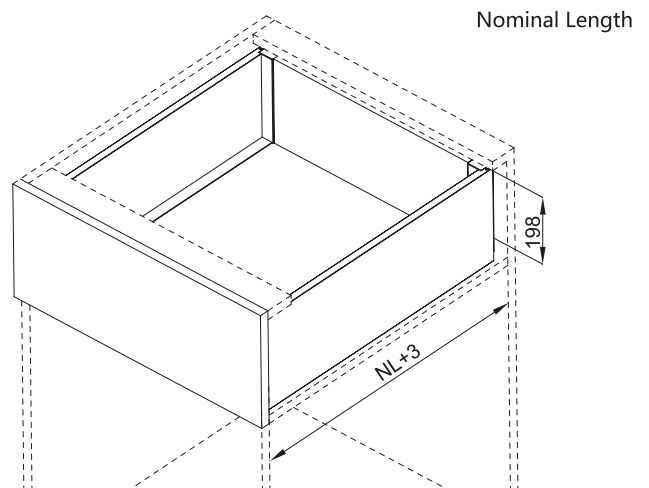

# TOPAZ SLIMLINE DRAWER SYSTEM

## TOPAZ SLIMLINE DRAWER H199

### ► H199 Tall, 199mm high

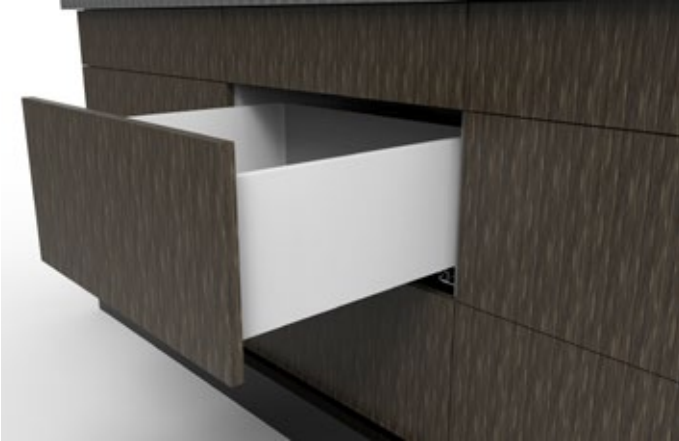

- Tall 199mm, ideal for pot drawers or as deep drawers in wardrobes
- Synchronised soft-closing slide runners
- 40 kg load capacity
- Wide range of drawer lengths NL350 to NL550mm
- 3D drawer front adjustment, up & down  $\pm 1.5$ mm, left & right  $\pm 1.5$ mm
- Choice of screw-fix or expanding dowel front brackets

### ► H199 Drawer Configuration

#### A TSL1 Soft-closing drawer slides (pair)

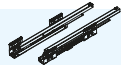

Length	CODE
NL350	TSL1.NL350.SC
NL400	TSL1.NL400.SC
NL450	TSL1.NL450.SC
NL500	TSL1.NL500.SC
NL550	TSL1.NL550.SC

#### B TSL2 - H199 Drawer sides, 199mm high (pair)

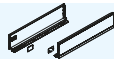

Length	CODE
NL350	TSL2.H199.350.W
NL400	TSL2.H199.400.W
NL450	TSL2.H199.450.W
NL500	TSL2.H199.500.W
NL550	TSL2.H199.550.W

#### C TSL3 - H199 Front connector brackets for H199 drawers (pair)

Type	CODE
SCREW-FIX H167/99	TSL3.FB167.199.S
EXPANDING DOWEL H167/199	TSL3.FB167.199.D



#### D TSL4 - H199 Rear brackets for H199 drawers (pair)



Type	CODE
H199	TSL4.RB199.W

Component view

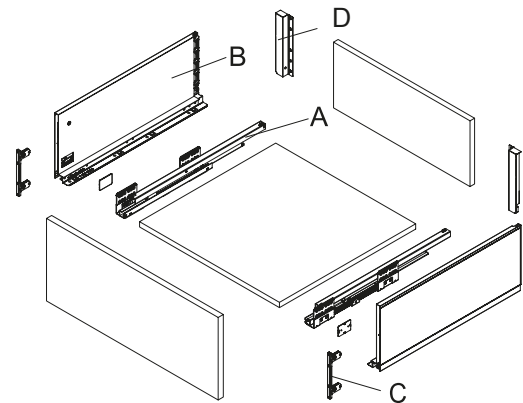

# TOPAZ SLIMLINE DRAWER SYSTEM

TOPAZ SLIMLINE DRAWER H199

## ► H199 Technical Information

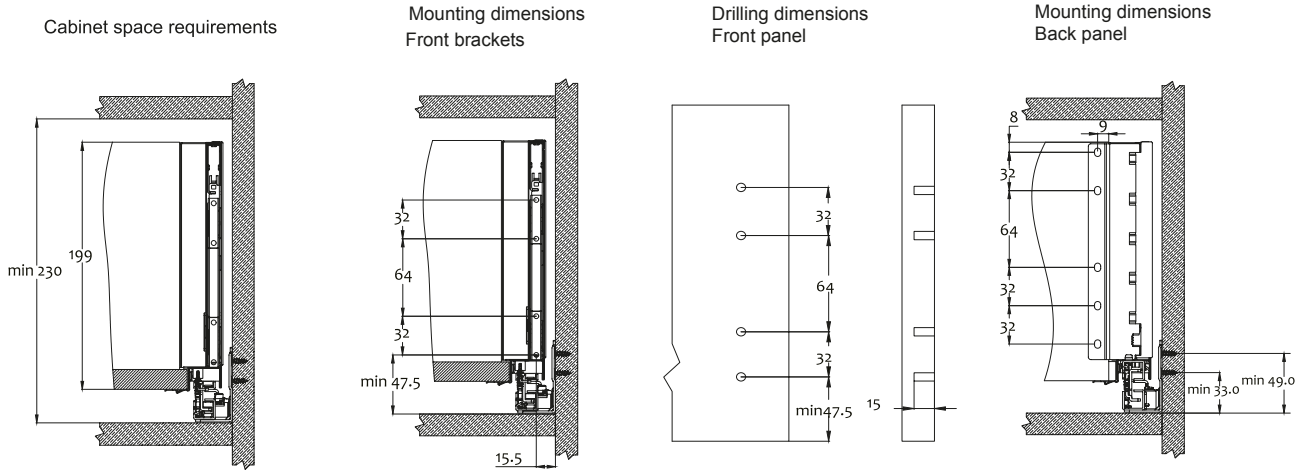

## DRAWER SLIDE DIMENSIONS

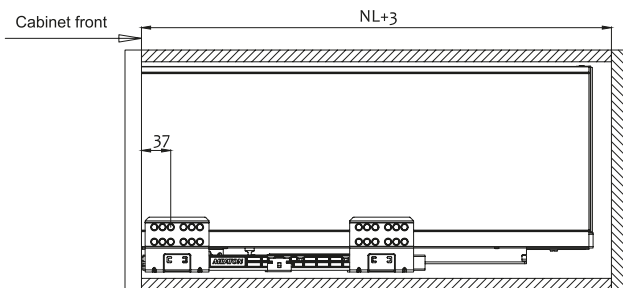
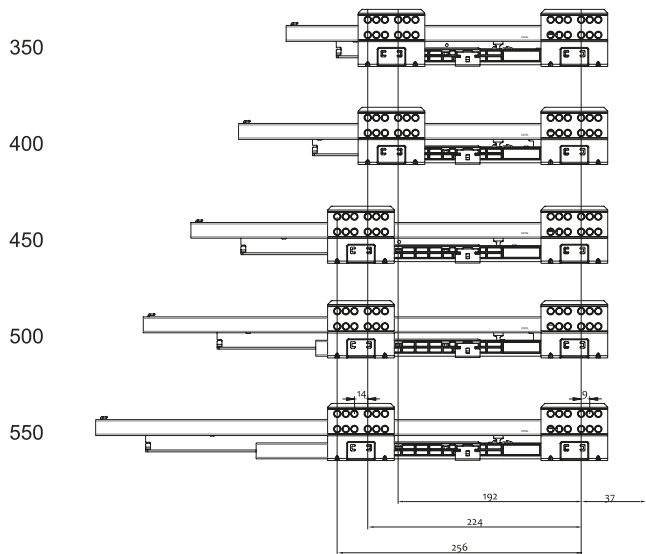

## CUTTING DIMENSIONS

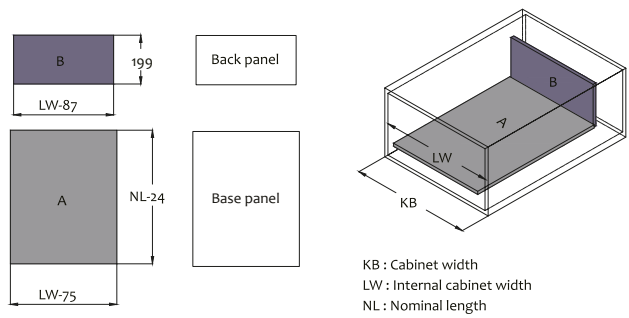

## SPACE REQUIREMENTS

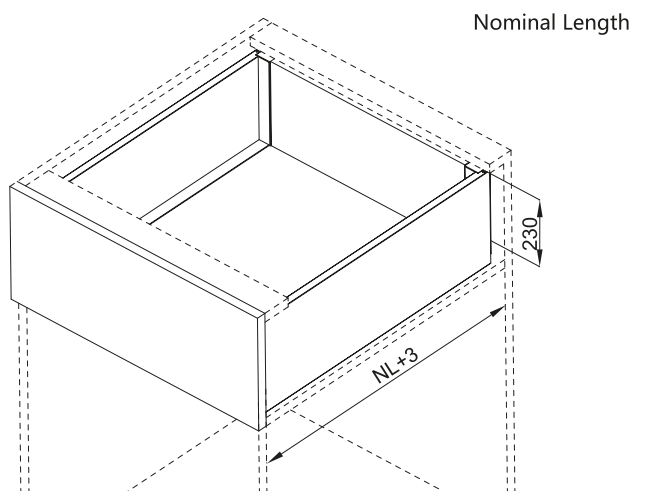

# TOPAZ SLIMLINE DRAWER SYSTEM

## INDEX PART NUMBERS

Part Number.....	Page
TSL1.NL350.SC .....	06, 08, 10, 12
TSL1.NL400.SC .....	06, 08, 10, 12
TSL1.NL450.SC .....	06, 08, 10, 12
TSL1.NL500.SC .....	06, 08, 10, 12
TSL1.NL550.SC .....	06, 08, 10, 12
TSL2.H86.350.W.....	06
TSL2.H86.400.W.....	06
TSL2.H86.450.W.....	06
TSL2.H86.500.W.....	06
TSL2.H86.550.W.....	06
TSL2.H118.350.W.....	08
TSL2.H118.400.W.....	08
TSL2.H118.450.W.....	08
TSL2.H118.500.W.....	08
TSL2.H118.550.W.....	08
TSL2.H167.350.W.....	10
TSL2.H167.400.W.....	10
TSL2.H167.450.W.....	10
TSL2.H199.350.W.....	12
TSL2.H199.400.W.....	12
TSL2.H199.450.W.....	12
TSL2.H199.500.W.....	12
TSL2.H199.550.W.....	12
TSL3.FB86.D .....	06
TSL3.FB86.S .....	06
TSL3.FB118.D .....	08
TSL3.FB118.S .....	08
TSL3.FB167.199.D .....	10, 12
TSL3.FB167.199.S .....	10, 12
TSL4.RB86.W .....	06
TSL4.RB118.W .....	08
TSL4.RB167.W .....	10
TSL4.RB199.W .....	12

# TOPAZ SLIMLINE DRAWER SYSTEM



**CABINET HARDWARE SYSTEMS**

# TOPAZ SLIMLINE DRAWER SYSTEM

# #DSY-TSL

## Australia

1800 008 591 ■ [www.artia.com.au](http://www.artia.com.au)

**VICTORIA:**

235 Settlement Road,  
Thomastown VIC 3074

**NEW SOUTH WALES:**

6 Nello Place  
Wetherill Park NSW 2164

**QUEENSLAND:**

Building 2/660 MacArthur  
Avenue, Pinkenba QLD 4008

**SOUTH AUSTRALIA:**

13 Rosberg Road,  
Wingfield SA 5013

**WESTERN AUSTRALIA:**

Unit 5/1 Dellamarta Road,  
Wangara WA 6065

## New Zealand

0800 267 625 ■ [www.artia.co.nz](http://www.artia.co.nz)

**AUCKLAND:**

11 Bruce Roderick Drive,  
East Tamaki, Auckland 2013

**CHRISTCHURCH:**

117 Wrights Road,  
Addington, Christchurch 8024