



# CABINET HARDWARE SYSTEMS

GRASS DWD XP DRAWER SYSTEMS

# #DSY-DWD

**1800 008 591**

[www.artia.com.au](http://www.artia.com.au)

**VICTORIA:**

235 Settlement Road,  
Thomastown VIC 3074

**NEW SOUTH WALES:**

Unit 1/429 Victoria Street,  
Wetherill Park NSW 2164

**QUEENSLAND:**

Building 2/660 MacArthur  
Avenue, Pinkenba QLD 4008

**SOUTH AUSTRALIA:**

13 Rosberg Road,  
Wingfield SA 5013

**WESTERN AUSTRALIA:**

Unit 1B/15 Hector Street,  
Osborne Park WA 6017

# CONTENTS

## GRASS DWD XP DRAWER SYSTEMS

04	H95 DRAWER
06	POT DRAWER H95 WITH RECTANGULAR RAILING
08	POT DRAWER H95 WITH ROUND RAILING
10	POT DRAWER H95 WITH VARIABLE BACK PANEL HEIGHT AND ROUND RAILING
12	POT DRAWER H95 WITH VARIABLE BACK PANEL HEIGHT AND DOUBLE RAILING
14	F8 INSET DRAWER H95
16	F8 INSET DRAWER H95 WITH RECTANGULAR RAILING

## GRASS DWD XP ACCESSORIES

18	FRONT BOTTOM CONNECTOR F8
18	DWD XP SPACER 25MM
18	MACHINE SCREWS
18	RECTANGULAR RAIL COVER CAP, WHITE

## GRASS DWD XP ASSEMBLY AIDS

19	DRILLING JIG FOR CABINET MEMBER
19	DRAWER FRONT MARKING JIG SET

# #DSY-DWD



CABINET HARDWARE SYSTEMS

**1800 008 591**

**VICTORIA:**  
235 Settlement Road,  
Thomastown VIC 3074

**NEW SOUTH WALES:**  
Unit 1/429 Victoria Street,  
Wetherill Park NSW 2164

**QUEENSLAND:**  
Building 2/660 MacArthur  
Avenue, Pinkenba QLD 4008

**SOUTH AUSTRALIA:**  
13 Rosberg Road,  
Wingfield SA 5013

**WESTERN AUSTRALIA:**  
Unit 1B/15 Hector Street,  
Osborne Park WA 6017

[www.artia.com.au](http://www.artia.com.au)

# DRAWER SYSTEMS

GRASS DWD XP DRAWER SYSTEMS



DWD XP not only looks good, but is also very versatile. It has become the benchmark for double-wall drawer systems.

**G\*GRASS®**



The extraordinary running performance of the DWD XP runners with their liquid-filled soft-close damper combine with the elegant design of the double-wall drawer sides to form a drawer system of the highest quality.

Grass DWD XP drawer systems are available in two configurations; trade packs and select single kits:

1. **TRADE PACKS** with sides and runners for 20 drawers, which can be configured to individual requirements with front holders and back clips, as well as choice of gallery rails or inset panels to suit the job.
2. **SINGLE KITS** of H95 standard drawers, individually packed and complete with front holders and back clips, to complete any job where only small quantities of a length are required.

**G\*GRASS®**

**1800 008 591**

[www.artia.com.au](http://www.artia.com.au)

**VICTORIA:**  
235 Settlement Road,  
Thomastown VIC 3074

**NEW SOUTH WALES:**  
Unit 1/429 Victoria Street,  
Wetherill Park NSW 2164

**QUEENSLAND:**  
Building 2/660 MacArthur  
Avenue, Pinkenba QLD 4008

**SOUTH AUSTRALIA:**  
13 Rosberg Road,  
Wingfield SA 5013

**WESTERN AUSTRALIA:**  
Unit 1B/15 Hector Street,  
Osborne Park WA 6017

**artia**

**CABINET HARDWARE SYSTEMS**

DSY-DWD ■ 03

# DRAWER SYSTEMS

## GRASS DWD XP DRAWER SYSTEMS

### H95 DRAWER



#### To be configured from Trade Packs or Single Kits

- Fully synchronised slide technology without mid-way knock
- Excellent running characteristics
- Maximum stability, minimal drawer deflection
- Integrated side and eccentric height adjustment including locking screw
- Stable front holder
- Removal and transport protection
- Same width of bottom and back panel, further machining not required

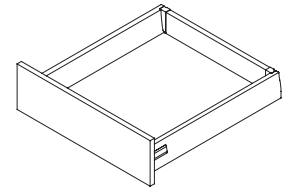

#### DWD XP Trade Packs for 20 drawers

- 1 DWD XP drawer sides H95, with cover caps
- 2 DWD XP Full extension slides with soft-close

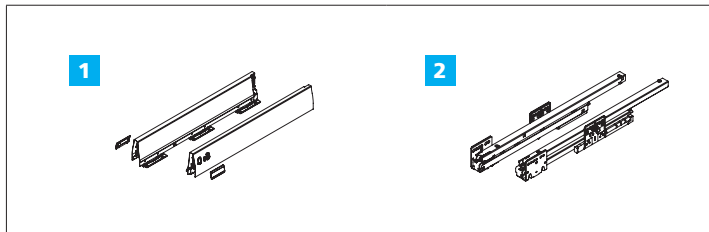

NL	Sides	Slides
275	F090075282211	F091075473211
350	F090075286211	F091075474211
400	F090075290211	F091075475211
450	F090075294211	F091075476211
500	F090075298211	F091075477211
550	F090075302211	F091075478211

#### DWD XP Kit for single H95 drawer:

- I DWD XP Drawer sides H95 incl. cover caps
- II DWD XP Full extension slides with soft-close
- III Set of clips for wooden back panels, H86
- IV Set of front holders for screw-fixing

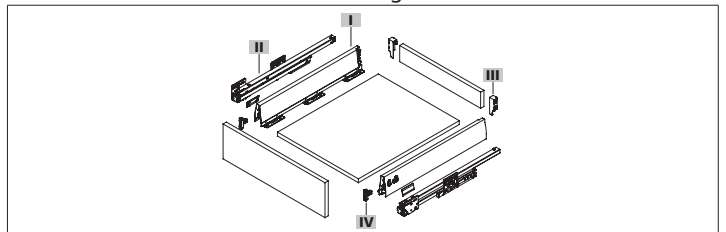

NL	White (Single Kit)
275	F090115141201
350	F090115142201
400	F090075396201
450	F090075399201
500	F090075402201
550	F090115143201

- 3 Clips set for wooden back panel H86 (set of RH and LH), to be ordered as required



White
F092082928233

- 4 Front holder, (non-sided, each), to be ordered as required

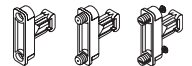

For screw fixing	For press fitting	Expansion dowel
F092083116239	F092083117239	F092083119239

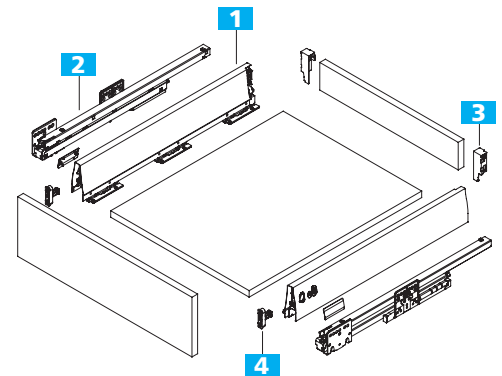

CABINET HARDWARE SYSTEMS

1800 008 591

VICTORIA:  
235 Settlement Road,  
Thomastown VIC 3074

NEW SOUTH WALES:  
Unit 1/429 Victoria Street,  
Wetherill Park NSW 2164

QUEENSLAND:  
Building 2/660 MacArthur  
Avenue, Pinkenba QLD 4008

SOUTH AUSTRALIA:  
13 Rosberg Road,  
Wingfield SA 5013

WESTERN AUSTRALIA:  
Unit 1B/15 Hector Street,  
Osborne Park WA 6017

www.artia.com.au

# DRAWER SYSTEMS

GRASS DWD XP DRAWER SYSTEMS

## INSTALLATION INFORMATION

All dimensions in millimetres

### INSTALLATION DIMENSIONS

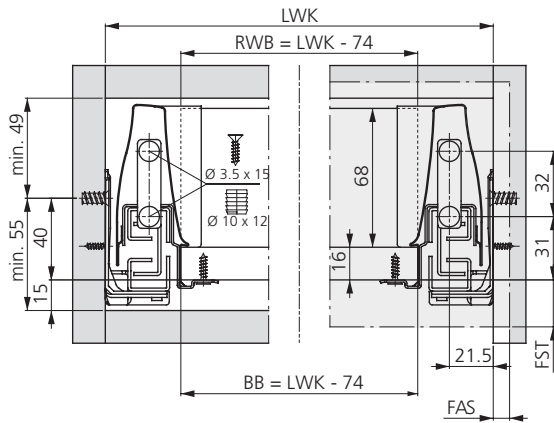

### CUTTING DIMENSIONS FOR 16MM BOARD

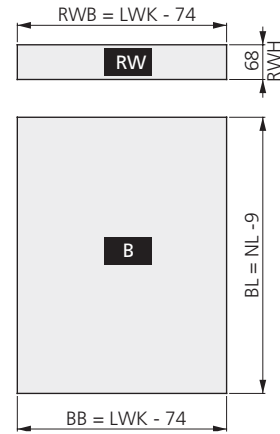

### FIXING POSITIONS FOR FULL EXTENSION DRAWER

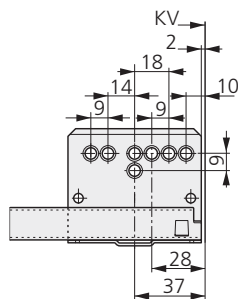

Special Euro screw  $\varnothing$  6.3 x 14 mm

Chipboard screw  $\varnothing$  3.5 x 15 mm

Screw head  $\varnothing$  7 mm

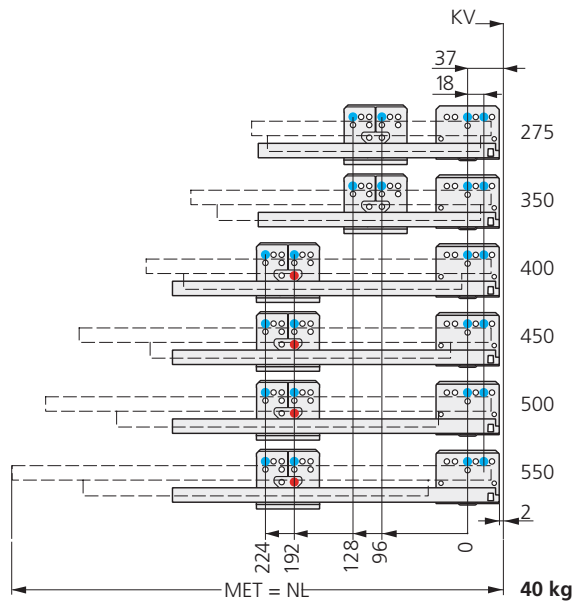

### LEGEND

B	Bottom panel	EB	Construction width	FST	Front overlay	LWK	Inside cabinet width	NL	Nominal length	RWB	Width of back panel
BB/BL	Bottom width / Bottom length	FAS	Front overlay, side	KV	Front edge of cabinet	MET	Minimum installation depth	RW	Back panel	RWH	Height of back panel

1800 008 591

[www.artia.com.au](http://www.artia.com.au)

**VICTORIA:**  
235 Settlement Road,  
Thomastown VIC 3074

**NEW SOUTH WALES:**  
Unit 1/429 Victoria Street,  
Wetherill Park NSW 2164

**QUEENSLAND:**  
Building 2/660 MacArthur  
Avenue, Pinkenba QLD 4008

**SOUTH AUSTRALIA:**  
13 Rosberg Road,  
Wingfield SA 5013

**WESTERN AUSTRALIA:**  
Unit 1B/15 Hector Street,  
Osborne Park WA 6017

**artia**

CABINET HARDWARE SYSTEMS

DSY-DWD ■ 05

# DRAWER SYSTEMS

## GRASS DWD XP DRAWER SYSTEMS

### POT DRAWER H95 WITH RECTANGULAR RAILING



To be configured from Trade Packs or Single Kits

- Fully synchronised slide technology without mid-way knock
- Excellent running characteristics
- Maximum stability, minimal drawer deflection
- Integrated side and eccentric height adjustment including locking screw
- Tilt angle adjustment using railing holder
- Stable front holder
- Removal and transport protection
- Same width of bottom and back panel, further machining not required

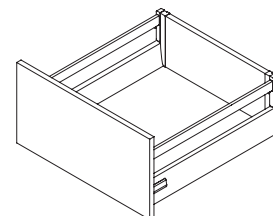

#### DWD XP Trade Packs for 20 drawers

- 1 DWD XP drawer sides H95, with cover caps
- 2 DWD XP Full extension slides with soft-close

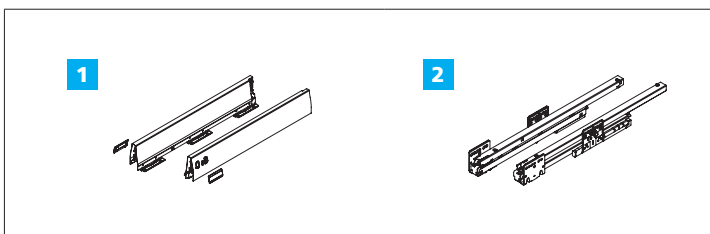

NL	Sides	Slides
275	F090075282211	F091075473211
350	F090075286211	F091075474211
400	F090075290211	F091075475211
450	F090075294211	F091075476211
500	F090075298211	F091075477211
550	F090075302211	F091075478211

#### DWD XP Kit for single H95 drawer:

- I DWD XP Drawer sides H95 incl. cover caps
- II DWD XP Full extension slides with soft-close
- III Set of clips for wooden back panels, H86
- IV Set of front holders for screw-fixing

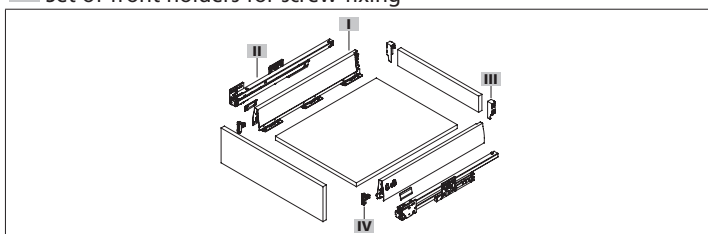

NL	White (Single Kit)
275	F090115141201
350	F090115142201
400	F090075396201
450	F090075399201
500	F090075402201
550	F090115143201

- 3 Clip set for wooden back panel H182 (set of RH and LH), to be ordered as required



White
F092082946223

- 4 Front holder, (non-sided, each), to be ordered as required

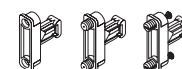

For screw fixing	For press fitting	Expansion dowel
F092083116239	F092083117239	F092083119239

- 5 Rectangular screw fixing railing set consisting of items 5a, 5b, 5c, 5d, to be order as required

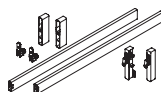

NL	WHITE
400	F092072183507
450	F092072184507
500	F092072185507
550	F092072186507

Not available for NL275 or NL350

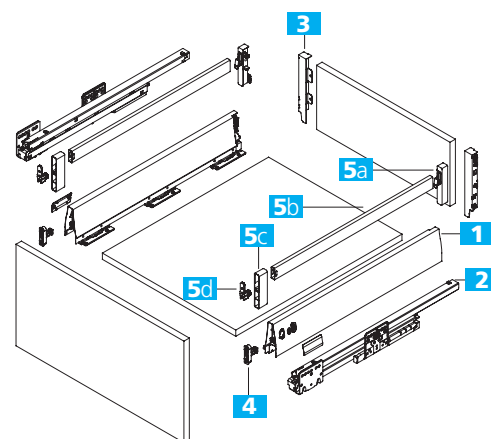

CABINET HARDWARE SYSTEMS

1800 008 591

VICTORIA:  
235 Settlement Road,  
Thomastown VIC 3074

NEW SOUTH WALES:  
Unit 1/429 Victoria Street,  
Wetherill Park NSW 2164

QUEENSLAND:  
Building 2/660 MacArthur  
Avenue, Pinkenba QLD 4008

SOUTH AUSTRALIA:  
13 Rosberg Road,  
Wingfield SA 5013

WESTERN AUSTRALIA:  
Unit 1B/15 Hector Street,  
Osborne Park WA 6017

www.artia.com.au

# DRAWER SYSTEMS

GRASS DWD XP DRAWER SYSTEMS

## INSTALLATION INFORMATION

All dimensions in millimetres

### Installation dimensions

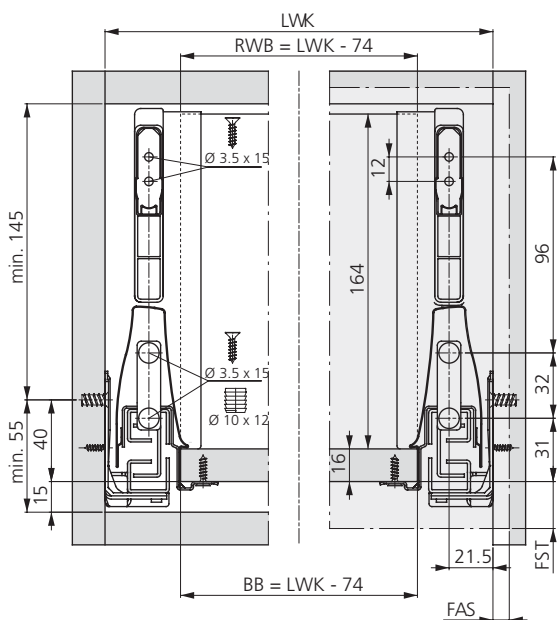

### Cutting dimensions for 16mm board

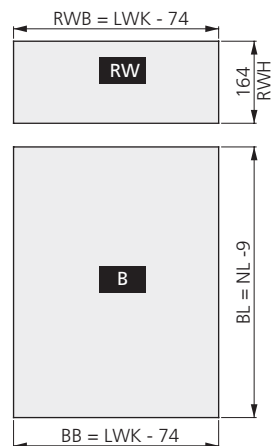

### Front tilt angle adjustment

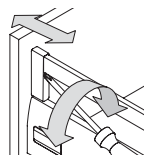

### Fixing positions for full extension drawer

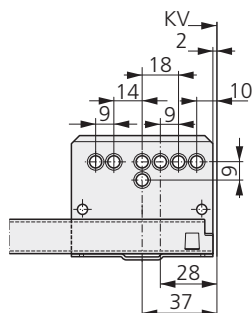

Special Euro screw  $\varnothing 6.3 \times 14$  mm  
Chipboard screw  $\varnothing 3.5 \times 15$  mm  
Screw head  $\varnothing 7$  mm

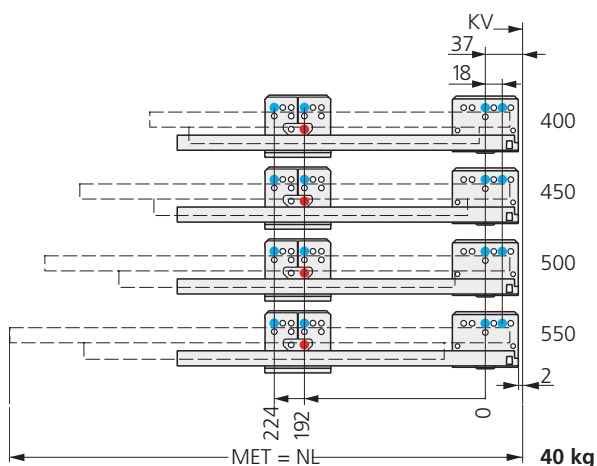

### LEGEND

B	Bottom panel	EB	Construction width	FST	Front overlay	LWK	Inside cabinet width	NL	Nominal length	RWB	Width of back panel
BB/BL	Bottom width / Bottom length	FAS	Front overlay, side	KV	Front edge of cabinet	MET	Minimum installation depth	RW	Back panel	RWH	Height of back panel

**1800 008 591**

[www.artia.com.au](http://www.artia.com.au)

**VICTORIA:**  
235 Settlement Road,  
Thomastown VIC 3074

**NEW SOUTH WALES:**  
Unit 1/429 Victoria Street,  
Wetherill Park NSW 2164

**QUEENSLAND:**  
Building 2/660 MacArthur  
Avenue, Pinkenba QLD 4008

**SOUTH AUSTRALIA:**  
13 Rosberg Road,  
Wingfield SA 5013

**WESTERN AUSTRALIA:**  
Unit 1B/15 Hector Street,  
Osborne Park WA 6017

**artia**

**CABINET HARDWARE SYSTEMS**

DSY-DWD ■ 07



# DRAWER SYSTEMS

## GRASS DWD XP DRAWER SYSTEMS

### ▶ POT DRAWER H95 WITH ROUND RAILING



#### To be configured from Trade Packs or Single Kits

- Fully synchronised slide technology without mid-way knock
- Excellent running characteristics
- Maximum stability, minimal drawer deflection
- Integrated side and eccentric height adjustment including locking screw
- Tool-free tilt angle adjustment using round railing
- Stable front holder
- Removal and transport protection
- Same width of bottom and back panel, further machining not required

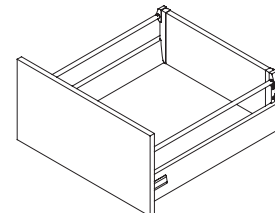

#### DWD XP Trade Packs for 20 drawers

- 1 DWD XP drawer sides H95, with cover caps
- 2 DWD XP Full extension slides with soft-close

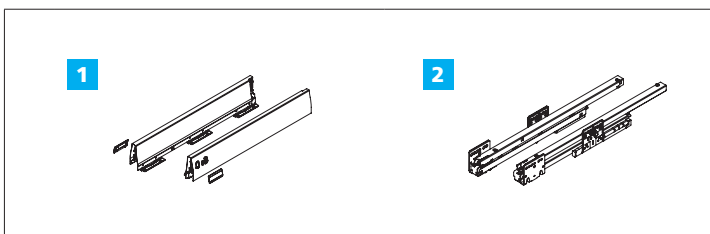

NL	Sides	Slides
275	F090075282211	F091075473211
350	F090075286211	F091075474211
400	F090075290211	F091075475211
450	F090075294211	F091075476211
500	F090075298211	F091075477211
550	F090075302211	F091075478211

#### DWD XP Kit for single H95 drawer:

- I DWD XP Drawer sides H95 incl. cover caps
- II DWD XP Full extension slides with soft-close
- III Set of clips for wooden back panels, H86
- IV Set of front holders for screw-fixing

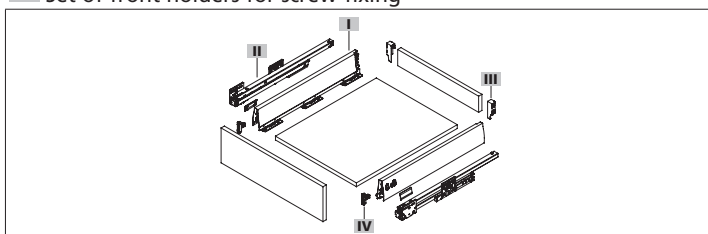

NL	White (Single Kit)
275	F090115141201
350	F090115142201
400	F090075396201
450	F090075399201
500	F090075402201
550	F090115143201

- 3 Clip set for wooden back panel H182 (set of RH and LH), to be ordered as required



White
F092082946223

- 4 Front holder, (non-sided, each), to be ordered as required

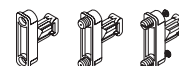

For screw fixing	For press fitting	Expansion dowel
F092083116239	F092083117239	F092083119239

- 5 Round railing set for screw fixing (pair), to be ordered as required



NL	White
350	F092075876513
400	F092075879513
450	F092075882513
500	F092075885513
550	F092075888513

Not available for NL275

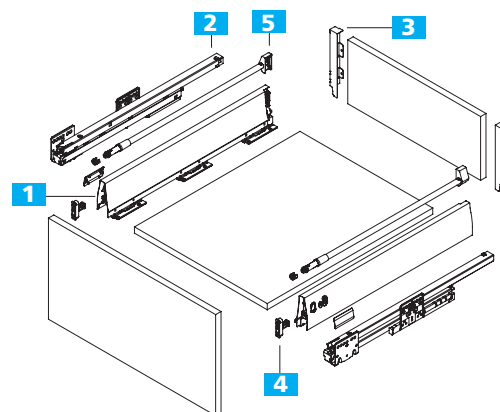

CABINET HARDWARE SYSTEMS

1800 008 591

**VICTORIA:**  
235 Settlement Road,  
Thomastown VIC 3074

**NEW SOUTH WALES:**  
Unit 1/429 Victoria Street,  
Wetherill Park NSW 2164

**QUEENSLAND:**  
Building 2/660 MacArthur  
Avenue, Pinkenba QLD 4008

**SOUTH AUSTRALIA:**  
13 Rosberg Road,  
Wingfield SA 5013

**WESTERN AUSTRALIA:**  
Unit 1B/15 Hector Street,  
Osborne Park WA 6017

www.artia.com.au



# DRAWER SYSTEMS

GRASS DWD XP DRAWER SYSTEMS

## INSTALLATION INFORMATION

All dimensions in millimetres

### Installation dimensions

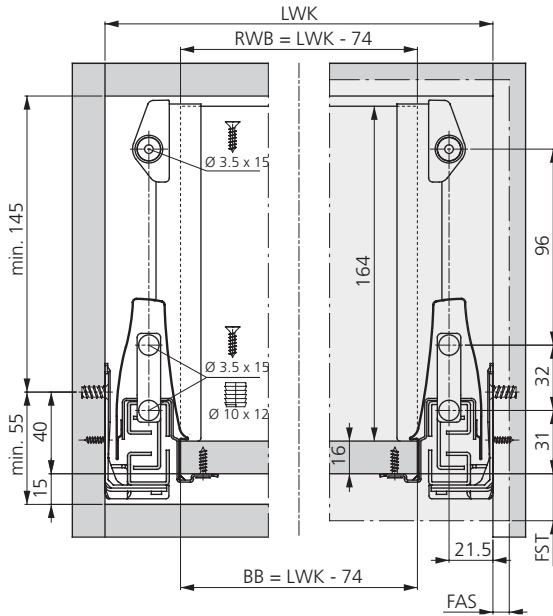

### Cutting dimensions for 16mm board

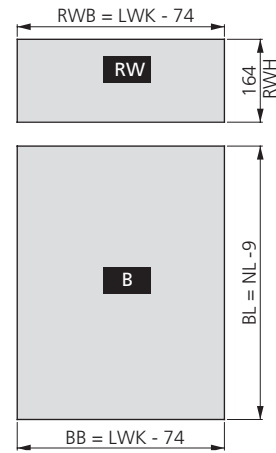

### Front tilt angle adjustment

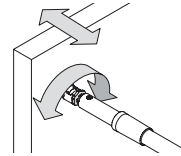

### Screw fixing of railing

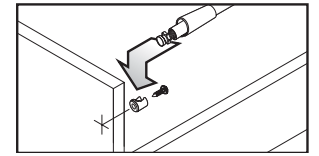

### Fixing positions for full extension drawer

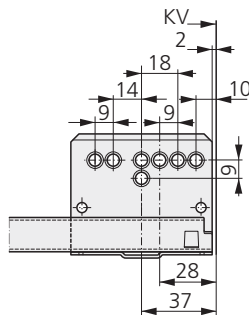

Special Euro screw  $\varnothing$  6.3 x 14 mm  
Chipboard screw  $\varnothing$  3.5 x 15 mm  
Screw head  $\varnothing$  7 mm

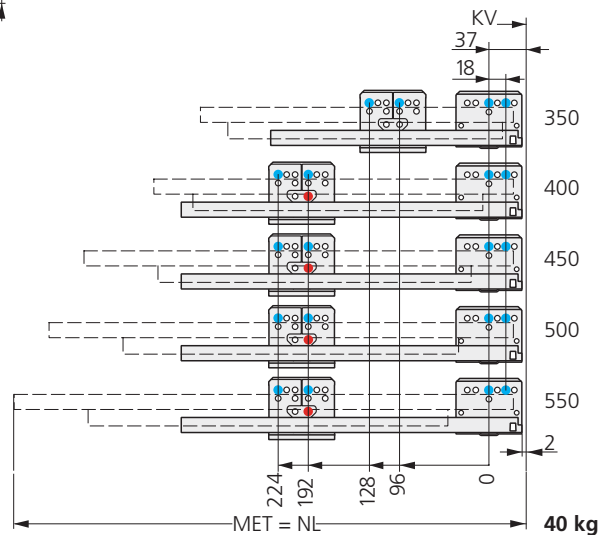

### LEGEND

B	Bottom panel	EB	Construction width	FST	Front overlay	LWK	Inside cabinet width	NL	Nominal length	RWB	Width of back panel
BB/BL	Bottom width / Bottom length	FAS	Front overlay, side	KV	Front edge of cabinet	MET	Minimum installation depth	RW	Back panel	RWH	Height of back panel

**1800 008 591**

[www.artia.com.au](http://www.artia.com.au)

**VICTORIA:**  
235 Settlement Road,  
Thomastown VIC 3074

**NEW SOUTH WALES:**  
Unit 1/429 Victoria Street,  
Wetherill Park NSW 2164

**QUEENSLAND:**  
Building 2/660 MacArthur  
Avenue, Pinkenba QLD 4008

**SOUTH AUSTRALIA:**  
13 Rosberg Road,  
Wingfield SA 5013

**WESTERN AUSTRALIA:**  
Unit 1B/15 Hector Street,  
Osborne Park WA 6017

**artia**

**CABINET HARDWARE SYSTEMS**

DSY-DWD ■ 09

# DRAWER SYSTEMS

## GRASS DWD XP DRAWER SYSTEMS

### ▶ POT DRAWER H95 WITH VARIABLE BACK PANEL HEIGHT AND ROUND RAILING



To be configured from Trade Packs or Single Kits

- Choice of back panel height
- Fully synchronised slide technology without mid-way knock
- Excellent running characteristics
- Maximum stability, minimal drawer deflection
- Integrated side and eccentric height adjustment including locking screw
- Tool-free tilt angle adjustment using round railing
- Stable front holder
- Removal and transport protection
- Same width of bottom and back panel, further machining not required

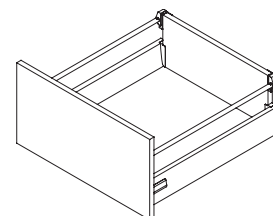

#### DWD XP Trade Packs for 20 drawers

- 1 DWD XP drawer sides H95, with cover caps
- 2 DWD XP Full extension slides with soft-close

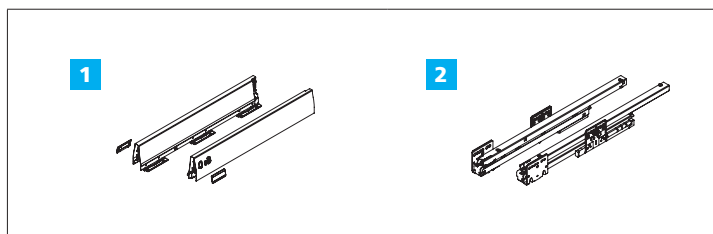

NL	Sides	Slides
275	F090075282211	F091075473211
350	F090075286211	F091075474211
400	F090075290211	F091075475211
450	F090075294211	F091075476211
500	F090075298211	F091075477211
550	F090075302211	F091075478211

#### DWD XP Kit for single H95 drawer:

- I DWD XP Drawer sides H95 incl. cover caps
- II DWD XP Full extension slides with soft-close
- III Set of clips for wooden back panels, H86
- IV Set of front holders for screw-fixing

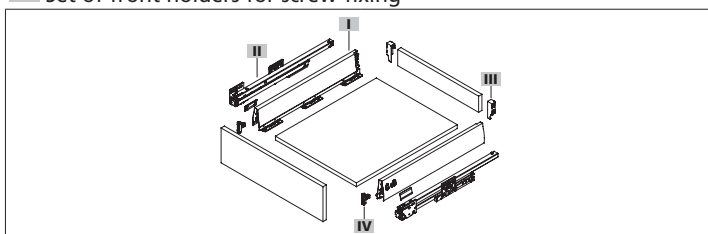

NL	White (Single Kit)
275	F090115141201
350	F090115142201
400	F090075396201
450	F090075399201
500	F090075402201
550	F090115143201

- 3 Front holder, (non-sided, each), to be ordered as required

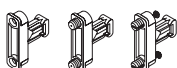

For screw fixing	For press fitting	Expansion dowel
F092083116239	F092083117239	F092083119239

- 4 Clip set for variable wooden back panel (consisting of 4a and 4b for RH and LH), to be ordered as required



White
F092082989523

- 5 Round railing set for screw fixing (pair), to be ordered as required



NL	White
350	F092075876513
400	F092075879513
450	F092075882513
500	F092075885513
550	F092075888513

Not available for NL275

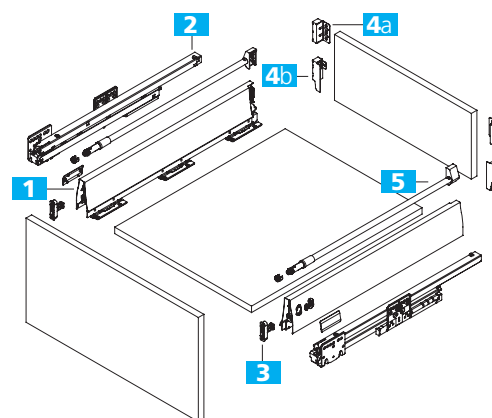

CABINET HARDWARE SYSTEMS

1800 008 591

**VICTORIA:**  
235 Settlement Road,  
Thomastown VIC 3074

**NEW SOUTH WALES:**  
Unit 1/429 Victoria Street,  
Wetherill Park NSW 2164

**QUEENSLAND:**  
Building 2/660 MacArthur  
Avenue, Pinkenba QLD 4008

**SOUTH AUSTRALIA:**  
13 Rosberg Road,  
Wingfield SA 5013

**WESTERN AUSTRALIA:**  
Unit 1B/15 Hector Street,  
Osborne Park WA 6017

www.artia.com.au

# DRAWER SYSTEMS

GRASS DWD XP DRAWER SYSTEMS

## INSTALLATION INFORMATION

All dimensions in millimetres

### Installation dimensions

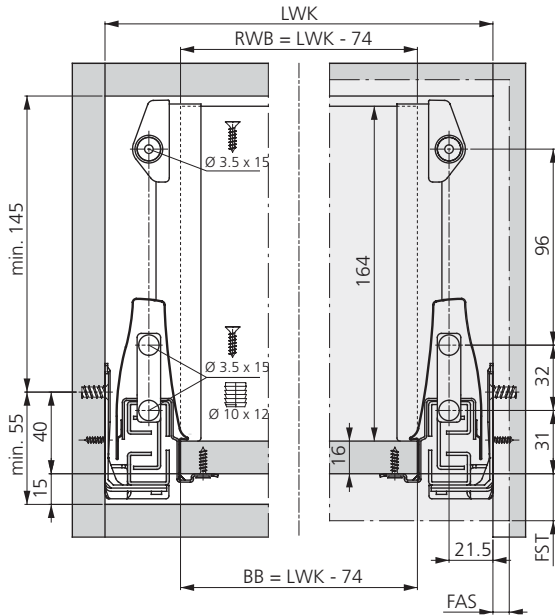

### Cutting dimensions for 16mm board

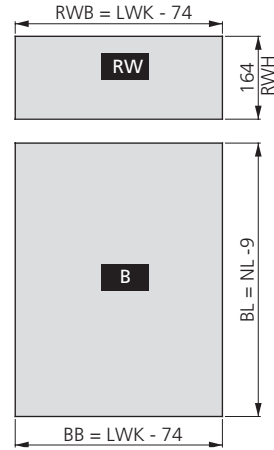

### Front tilt angle adjustment

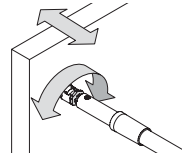

### Screw fixing of railing

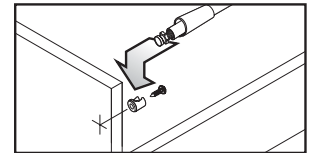

### Fixing positions for full extension drawer

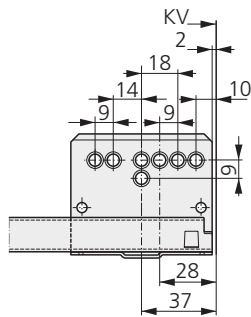

Special Euro screw  $\varnothing$  6.3 x 14 mm  
Chipboard screw  $\varnothing$  3.5 x 15 mm  
Screw head  $\varnothing$  7 mm

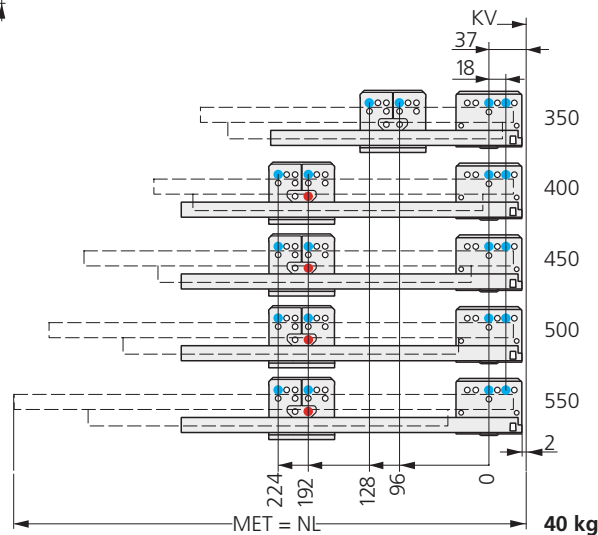

### LEGEND

B	Bottom panel	EB	Construction width	FST	Front overlay	LWK	Inside cabinet width	NL	Nominal length	RWB	Width of back panel
BB/BL	Bottom width / Bottom length	FAS	Front overlay, side	KV	Front edge of cabinet	MET	Minimum installation depth	RW	Back panel	RWH	Height of back panel

**1800 008 591**

[www.artia.com.au](http://www.artia.com.au)

**VICTORIA:**  
235 Settlement Road,  
Thomastown VIC 3074

**NEW SOUTH WALES:**  
Unit 1/429 Victoria Street,  
Wetherill Park NSW 2164

**QUEENSLAND:**  
Building 2/660 MacArthur  
Avenue, Pinkenba QLD 4008

**SOUTH AUSTRALIA:**  
13 Rosberg Road,  
Wingfield SA 5013

**WESTERN AUSTRALIA:**  
Unit 1B/15 Hector Street,  
Osborne Park WA 6017

**artia**

**CABINET HARDWARE SYSTEMS**

DSY-DWD ■ 11

# DRAWER SYSTEMS

## GRASS DWD XP DRAWER SYSTEMS

### ▶ POT DRAWER H95 WITH VARIABLE BACK PANEL HEIGHT AND DOUBLE RAILING



To be configured from Trade Packs or Single Kits

- Maximum stability, minimal drawer deflection
- Choice of back panel height
- Integrated side and eccentric height adjustment including locking screw
- Tool-free tilt angle adjustment using round railing
- Strong front holder
- Safety lock and transport protection
- Same width of bottom and back panel, further machining not required

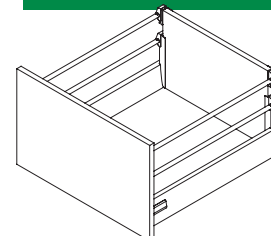

#### DWD XP Trade Packs for 20 drawers

- 1 DWD XP drawer sides H95, with cover caps
- 2 DWD XP Full extension slides with soft-close

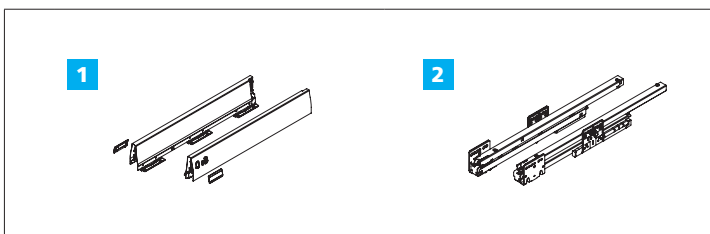

NL	Sides	Slides
275	F090075282211	F091075473211
350	F090075286211	F091075474211
400	F090075290211	F091075475211
450	F090075294211	F091075476211
500	F090075298211	F091075477211
550	F090075302211	F091075478211

#### DWD XP Kit for single H95 drawer:

- I DWD XP Drawer sides H95 incl. cover caps
- II DWD XP Full extension slides with soft-close
- III Set of clips for wooden back panels, H86
- IV Set of front holders for screw-fixing

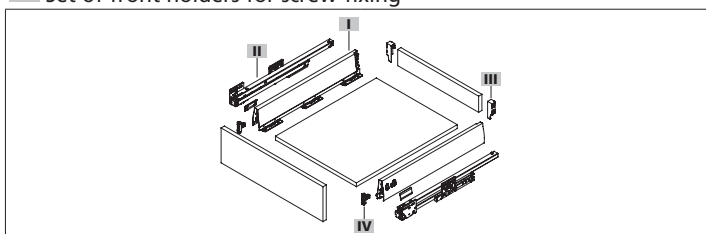

NL	White (Single Kit)
275	F090115141201
350	F090115142201
400	F090075396201
450	F090075399201
500	F090075402201
550	F090115143201

- 3 Clip set for variable wooden back panel, incl. back panel clip H182 (open) and railing clip (variable), one left, one right, to be ordered as required



White
F092082993523 (212814)

- 4 Front holder, (non-sided, each), to be ordered as required

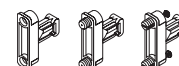

For screw fixing	For press fitting	Expansion dowel
F092083116239	F092083117239	F092083119239

- 5 Round railing set for screw fixing (pair), to be ordered as required



NL	White
350	F092075876513
400	F092075879513
450	F092075882513
500	F092075885513
550	F092075888513

For set-up with rectangular screw fixing railing sets, refer to 5 from POT DRAWER H95 WITH RECTANGULAR RAILING and also order two additional rectangular cover caps F145055341123 for the top rails (see accessories)

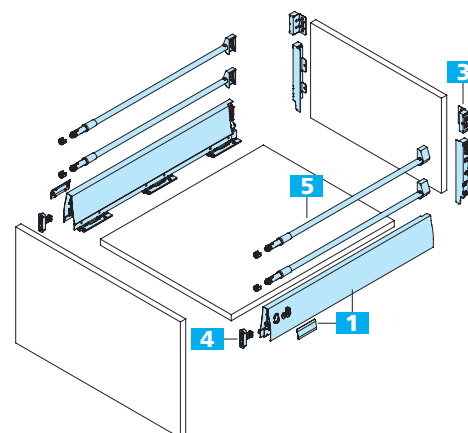

2 not shown



CABINET HARDWARE SYSTEMS

1800 008 591

VICTORIA:  
235 Settlement Road,  
Thomastown VIC 3074

NEW SOUTH WALES:  
Unit 1/429 Victoria Street,  
Wetherill Park NSW 2164

QUEENSLAND:  
Building 2/660 MacArthur  
Avenue, Pinkenba QLD 4008

SOUTH AUSTRALIA:  
13 Rosberg Road,  
Wingfield SA 5013

WESTERN AUSTRALIA:  
Unit 1B/15 Hector Street,  
Osborne Park WA 6017

www.artia.com.au



# DRAWER SYSTEMS

## GRASS DWD XP DRAWER SYSTEMS

### F8 INSET DRAWER H95



To be configured from Trade Packs or Single Kits

- Colour-coordinated aluminium front panel for cutting to length
- High-quality visual design due to the smooth inside and outside surfaces
- Same dimensions as for standard drawers (inside depth)
- Fully synchronised slide technology without mid-way knock
- Excellent running characteristics
- Same width of bottom and back panel, further machining not required
- Up to 1200 mm wide; to be cut to intermediate widths as required
- Front-bottom connector **F145117993223** recommended from 600 mm width (see accessories)

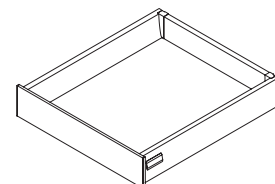

#### DWD XP Trade Packs for 20 drawers

- 1 DWD XP drawer sides H95, with cover caps
- 2 DWD XP Full extension slides with soft-close

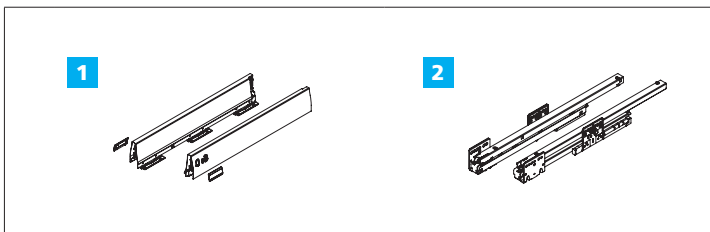

NL	Sides	Slides
275	<b>F090075282211</b>	<b>F091075473211</b>
350	<b>F090075286211</b>	<b>F091075474211</b>
400	<b>F090075290211</b>	<b>F091075475211</b>
450	<b>F090075294211</b>	<b>F091075476211</b>
500	<b>F090075298211</b>	<b>F091075477211</b>
550	<b>F090075302211</b>	<b>F091075478211</b>

#### DWD XP Kit for single H95 drawer:

- I DWD XP Drawer sides H95 incl. cover caps
- II DWD XP Full extension slides with soft-close
- III Set of clips for wooden back panels, H86
- IV Set of front holders for screw-fixing

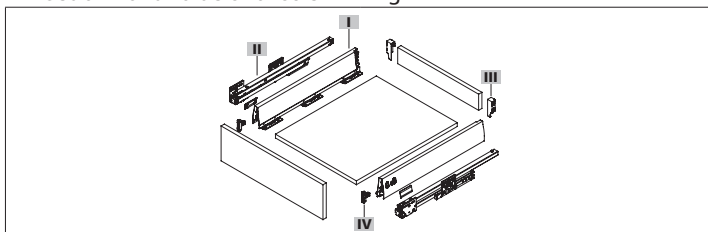

NL	White (Single Kit)
275	<b>F090115141201</b>
350	<b>F090115142201</b>
400	<b>F090075396201</b>
450	<b>F090075399201</b>
500	<b>F090075402201</b>
550	<b>F090115143201</b>

- 3 Clips set for wooden back panel H86 (set of RH and LH)  
Set to be ordered as required



White
<b>F092082928233</b>

- 4 Cover caps for F8 inset panel, (non-sided, each), to be ordered as required



White
<b>F102101382218</b>

- 5 F8 front panel profile  
Front panel profile without holes, to be ordered and cut to width as required

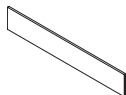

L	White
1200	<b>F102101369511</b>

- 6 Front holder for screw fixing (non-sided, each), to be ordered as required



For screw fixing
<b>F092101589223</b>

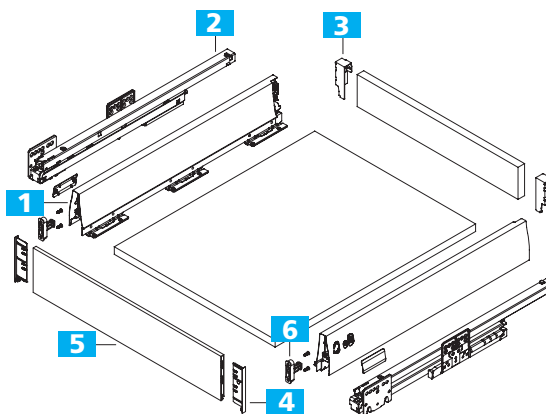

CABINET HARDWARE SYSTEMS

1800 008 591

www.artia.com.au

# DRAWER SYSTEMS

GRASS DWD XP DRAWER SYSTEMS

## INSTALLATION INFORMATION

All dimensions in millimetres

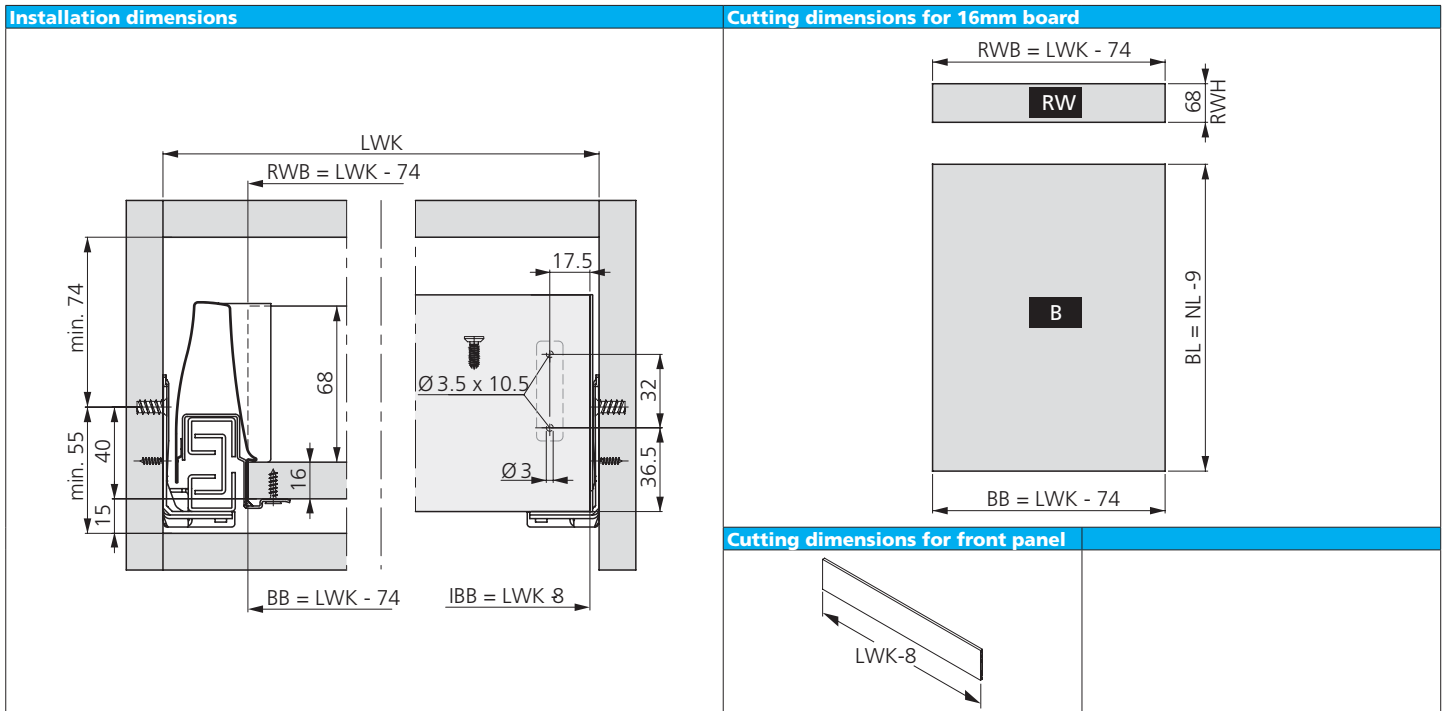

## Fixing positions for full extension drawer

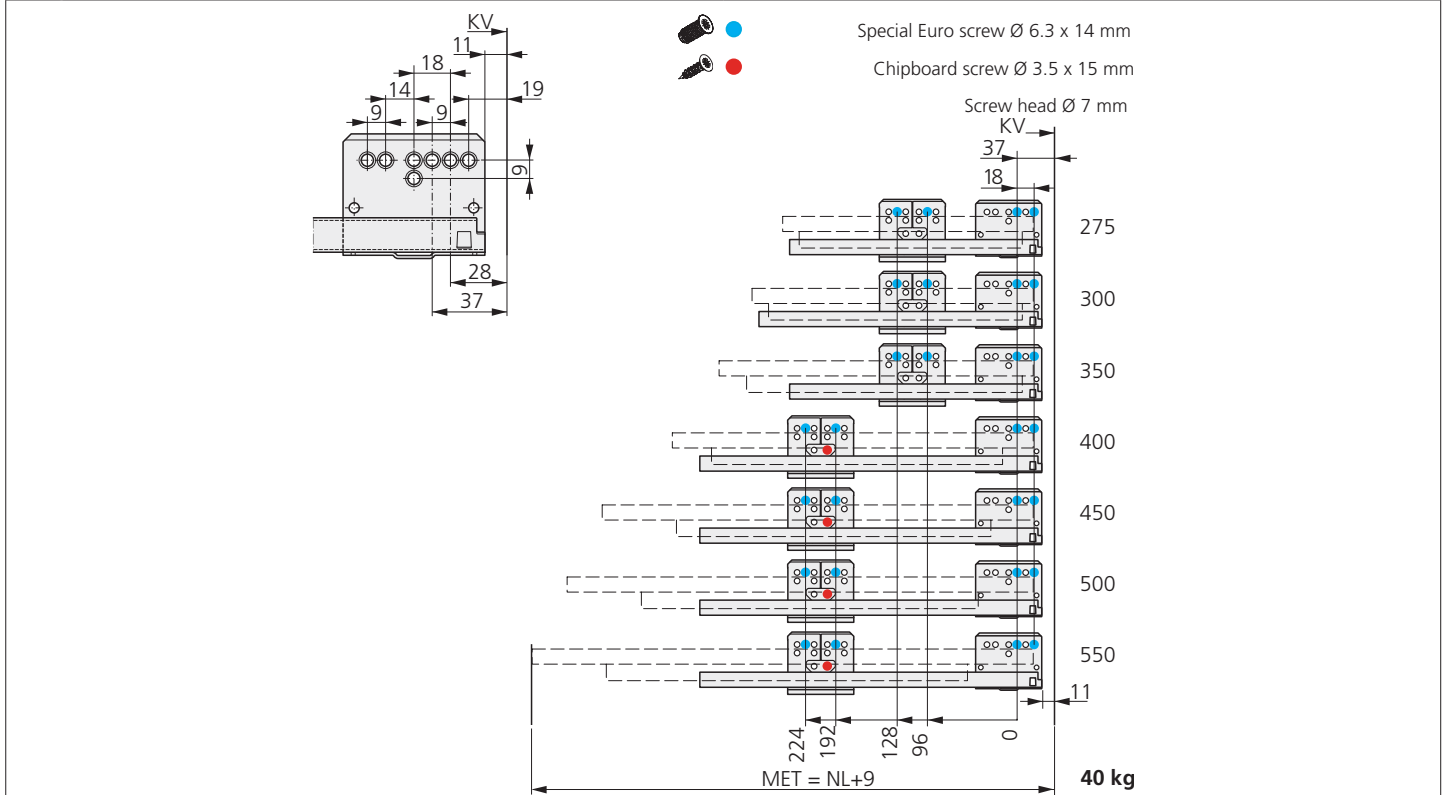

LEGEND											
<b>B</b>	Bottom panel	<b>EB</b>	Construction width	<b>FST</b>	Front overlay	<b>LWK</b>	Inside cabinet width	<b>NL</b>	Nominal length	<b>RWB</b>	Width of back panel
<b>BB/BL</b>	Bottom width / Bottom length	<b>FAS</b>	Front overlay, side	<b>KV</b>	Front edge of cabinet	<b>MET</b>	Minimum installation depth	<b>RW</b>	Back panel	<b>RWH</b>	Height of back panel

**1800 008 591**

[www.artia.com.au](http://www.artia.com.au)

**VICTORIA:**  
235 Settlement Road,  
Thomastown VIC 3074

**NEW SOUTH WALES:**  
Unit 1/429 Victoria Street,  
Wetherill Park NSW 2164

**QUEENSLAND:**  
Building 2/660 MacArthur  
Avenue, Pinkenba QLD 4008

**SOUTH AUSTRALIA:**  
13 Rosberg Road,  
Wingfield SA 5013

**WESTERN AUSTRALIA:**  
Unit 1B/15 Hector Street,  
Osborne Park WA 6017

**artia**

**CABINET HARDWARE SYSTEMS**



# DRAWER SYSTEMS

## GRASS DWD XP DRAWER SYSTEMS

### F8 INSET DRAWER H95 WITH RECTANGULAR RAILING

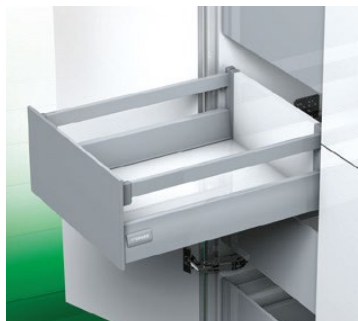

To be configured from Trade Packs or Single Kits

- Colour-coordinated aluminium front panel for cutting to length
- High-quality visual design due to the smooth inside and outside surfaces
- Same dimensions as for standard drawers (inside depth)
- Fully synchronised slide technology without mid-way knock
- Excellent running characteristics
- Same width of bottom and back panel, further machining not required
- Up to 1200 mm wide; to be cut to intermediate widths as required
- Front-bottom connector **F145117993**223 recommended from 600 mm width (see accessories)

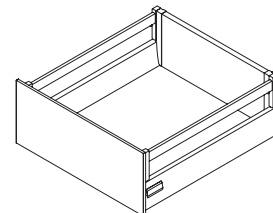

#### DWD XP Trade Packs for 20 drawers

- 1 DWD XP drawer sides H95, with cover caps
- 2 DWD XP Full extension slides with soft-close

NL	Sides	Slides
275	<b>F090075282</b> 211	<b>F091075473</b> 211
350	<b>F090075286</b> 211	<b>F091075474</b> 211
400	<b>F090075290</b> 211	<b>F091075475</b> 211
450	<b>F090075294</b> 211	<b>F091075476</b> 211
500	<b>F090075298</b> 211	<b>F091075477</b> 211
550	<b>F090075302</b> 211	<b>F091075478</b> 211

#### DWD XP Kit for single H95 drawer:

- I DWD XP Drawer sides H95 incl. cover caps
- II DWD XP Full extension slides with soft-close
- III Set of clips for wooden back panels, H86
- IV Set of front holders for screw-fixing

NL	White (Single Kit)
275	<b>F090115141</b> 201
350	<b>F090115142</b> 201
400	<b>F090075396</b> 201
450	<b>F090075399</b> 201
500	<b>F090075402</b> 201
550	<b>F090115143</b> 201

- 3 Clip set for wooden back panel H182 (set of RH and LH), to be ordered as required

White
<b>F092082928</b> 233

- 5 F8 inset panel profile without holes, to be ordered and cut to width as required

L	White
1200	<b>F102101377</b> 507

- 7 Rectangular screw fixing railing set (consisting of items 7a (1 x l/r), 7b (2x), 7c (1 x l/r), to be ordered as required

NL	WHITE
400	<b>F092072183</b> 507
450	<b>F092072184</b> 507
500	<b>F092072185</b> 507
550	<b>F092072186</b> 507

Not available for NL275 or NL350

- 4 Cover caps for F8 inset panel profile, (non-sided, each), to be ordered as required

White
<b>F102101449</b> 214

- 6 Front holder for screw fixing (non-sided, each), to be ordered as required. Also order 4 x machine screws **F145117998**239 for inset panel (ref. 7d)

Part Number
<b>F092101589</b> 223

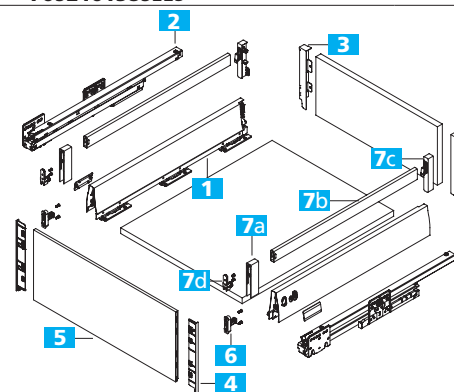

CABINET HARDWARE SYSTEMS

1800 008 591

www.artia.com.au

# DRAWER SYSTEMS

GRASS DWD XP DRAWER SYSTEMS

## INSTALLATION INFORMATION

All dimensions in millimetres

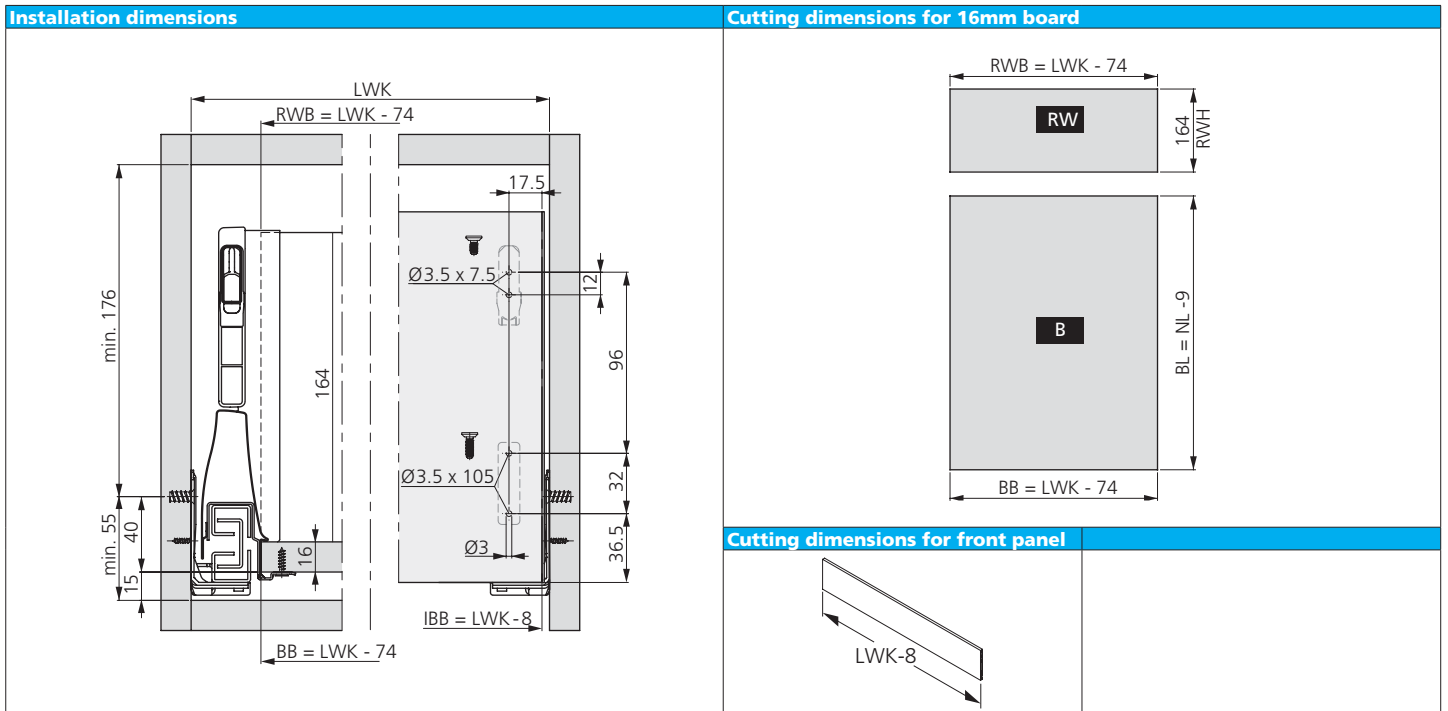

## Fixing positions for full extension drawer

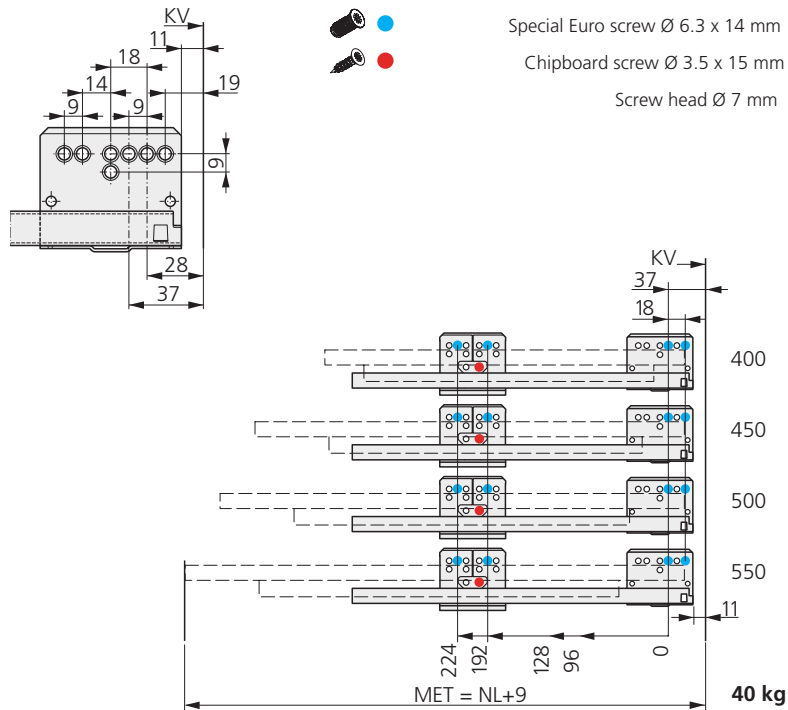

LEGEND											
<b>B</b>	Bottom panel	<b>EB</b>	Construction width	<b>FST</b>	Front overlay	<b>LWK</b>	Inside cabinet width	<b>NL</b>	Nominal length	<b>RWB</b>	Width of back panel
<b>BB/BL</b>	Bottom width / Bottom length	<b>FAS</b>	Front overlay, side	<b>KV</b>	Front edge of cabinet	<b>MET</b>	Minimum installation depth	<b>RW</b>	Back panel	<b>RWH</b>	Height of back panel

**1800 008 591**

[www.artia.com.au](http://www.artia.com.au)

**VICTORIA:**  
235 Settlement Road,  
Thomastown VIC 3074

**NEW SOUTH WALES:**  
Unit 1/429 Victoria Street,  
Wetherill Park NSW 2164

**QUEENSLAND:**  
Building 2/660 MacArthur  
Avenue, Pinkenba QLD 4008

**SOUTH AUSTRALIA:**  
13 Rosberg Road,  
Wingfield SA 5013

**WESTERN AUSTRALIA:**  
Unit 1B/15 Hector Street,  
Osborne Park WA 6017

**artia**

**CABINET HARDWARE SYSTEMS**

# DRAWER SYSTEMS

## GRASS DWD XP ACCESSORIES

### FRONT BOTTOM CONNECTOR F8

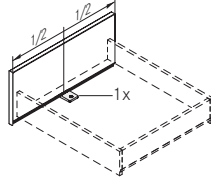
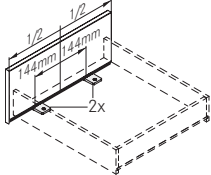
				PART NUMBER
<ul style="list-style-type: none"> <li>For wide drawers from a cabinet width of 600mm</li> </ul>		KB = 600mm - 800mm		<b>F145117993223</b>
		KB = 800mm - 1200mm		

### DWD XP SPACER 25mm

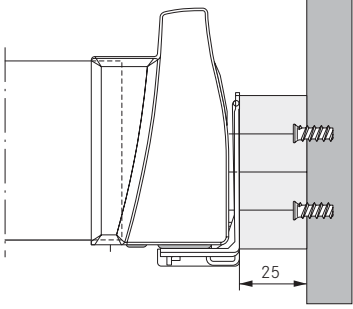
			PART NUMBER
<ul style="list-style-type: none"> <li>For inset drawers behind a door in order to bridge door protrusion</li> <li>Suitable for left and right</li> <li>Secure fastening of DWD XP full extension drawers with 40kg load capacity</li> </ul>			<b>F092083198217</b>

### MACHINE SCREWS

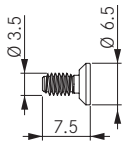
		PART NUMBER
<ul style="list-style-type: none"> <li>Self-tapping countersunk screw, M 3.5 x 7.5 mm</li> <li>For aluminium inset panels</li> </ul>		<b>F145117998239</b>

### RECTANGULAR RAIL COVER CAP, WHITE

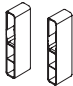
		PART NUMBER
<ul style="list-style-type: none"> <li>Required for top set of rails in double rail drawers with variable height</li> <li>To cover front connector</li> </ul>		<b>F145055341123</b>



**1800 008 591**

[www.artia.com.au](http://www.artia.com.au)

# DRAWER SYSTEMS

GRASS DWD XP ASSEMBLY AIDS

## ▶ DRILLING JIG FOR CABINET MEMBER

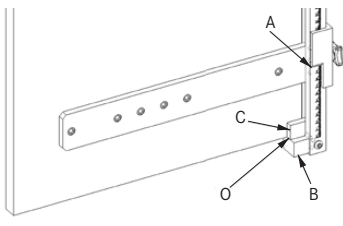
			PART NUMBER
<p>One set includes:</p> <ul style="list-style-type: none"> <li>▪ Guide rule (1x)</li> <li>▪ Marking elements (4x)</li> <li>▪ Stop plates B + C (1 each)</li> </ul> <p>A. Reading edge = centre of hole            B. Stop plate for loose cabinet parts            C. Stop plate for assembled cabinet            O. Zero scale position</p>			<p><b>F146094730501</b></p>

## ▶ DRAWER FRONT MARKING JIG SET

			PART NUMBER
<ul style="list-style-type: none"> <li>▪ Marking jig set for DWD XP front holder.</li> </ul> <p>One set includes:</p> <ul style="list-style-type: none"> <li>▪ Marking jig - left</li> <li>▪ Marking jig - right</li> <li>▪ Marker points (4x)</li> </ul>			<p><b>F146083256101</b></p>



**1800 008 591**

[www.artia.com.au](http://www.artia.com.au)

**VICTORIA:**  
235 Settlement Road,  
Thomastown VIC 3074

**NEW SOUTH WALES:**  
Unit 1/429 Victoria Street,  
Wetherill Park NSW 2164

**QUEENSLAND:**  
Building 2/660 MacArthur  
Avenue, Pinkenba QLD 4008

**SOUTH AUSTRALIA:**  
13 Rosberg Road,  
Wingfield SA 5013

**WESTERN AUSTRALIA:**  
Unit 1B/15 Hector Street,  
Osborne Park WA 6017

**artia**

**CABINET HARDWARE SYSTEMS**

# GRASS DWD XP DRAWER SYSTEMS

# #DSY-DWD



**CABINET HARDWARE SYSTEMS**

**1800 008 591**

[www.artia.com.au](http://www.artia.com.au)

**VICTORIA:**  
235 Settlement Road,  
Thomastown VIC 3074

**NEW SOUTH WALES:**  
Unit 1/429 Victoria Street,  
Wetherill Park NSW 2164

**QUEENSLAND:**  
Building 2/660 MacArthur  
Avenue, Pinkenba QLD 4008

**SOUTH AUSTRALIA:**  
13 Rosberg Road,  
Wingfield SA 5013

**WESTERN AUSTRALIA:**  
Unit 1B/15 Hector Street,  
Osborne Park WA 6017